



reform<sup>®</sup>  
sports

*13.000 Seats  
Indoor Sports Arena*



HEADQUARTER - İSTANBUL/TÜRKİYE

REFORM SPORTS



[reformsports.com](https://www.reformsports.com)



[info@reformsports.com](mailto:info@reformsports.com)



+90 212 533 70 73





# FACTORY

## TEKİRDAĞ/TÜRKİYE

TURF PRODUCTION CAPACITY 11.000.000 M<sup>2</sup> / YEAR •

RUBBER PRODUCTION CAPACITY 300.000 M<sup>2</sup> / YEAR •

STEEL CONSTRUCTION CAPACITY 12.000 TON / YEAR •

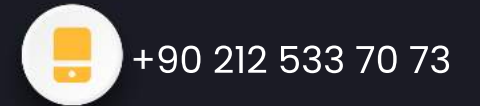

# ○ WE ARE LEADING ○

- **STADIUMS**

- **SPORTS ARENA**

- **TURN-KEY SPORTS COMPLEXES**

- **FIFA FOOTBALL FIELDS**

- **PROFESSIONAL FOOTBALL FIELDS**

- **HYBRID TURF FOOTBALL FIELDS**

- **ATHLETICS TRACKS**

- **METAL CONSTRUCTION**

- **INDOOR SPORTS COMPLEXES**

- **OUTDOOR SPORTS COMPLEXES**

- **PADEL COURTS**

- **FOOT 5 COURTS**

- **BASKETBALL, VOLLEYBALL, HANDBALL, TENNIS COURT**

- **HOCKEY, CRICKET FIELDS**

- **GOLF COURSES**

- **MULTISPORT FLOORING**

- **LANDSCAPING**

- **CHILDREN PLAY GROUNDS**



# WHY REFORM SPORTS?

- OVER 30 YEARS OF EXPERIENCE
- TURN-KEY SOLUTIONS
- FLEXIBILITY AND FAST DELIVERY
- ENVIRONMENTALLY FRIENDLY
- RECYCLABLE MATERIALS
- HIGH QUALITY AND COMPETITIVE PRICES
- WARRANTY AND DURABILITY
- INTERNATIONALLY CERTIFIED



[reformsports.com](https://reformsports.com)



[info@reformsports.com](mailto:info@reformsports.com)



+90 212 533 70 73



BRB  
HOLDING



reformsports®

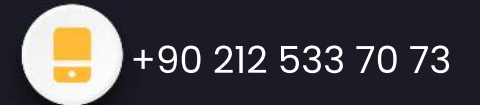
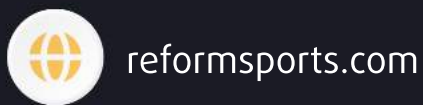



# HIGHEST QUALITY

CERTIFIED BY INTERNATIONAL AUTHORITIES





**7**  
**REGIONS**

**105**  
**COUNTRIES**

**15.000**  
**PROJECTS**



## AFRICA

NIGERIA	NIJER	ETHIOPIA	SOUTH SUDAN
GHANA	SIERRA LEONE	KENYA	MAURITIUS
SENEGAL	DEM. REP. OF CONGO	UGANDA	
IVORY COAST	CAMEROON	TANZANIA	
GAMBIA	KONGO	RWANDA	
MALI	GABON	MOZAMBIQUE	
GUINEA	CHAD	BURUNDI	
MAURITANIA	SOUTH AFRICA	DJIBOUTI	
BURKINA FASO	ZAMBIA	SOMALIA	
TOGO	SUDAN		

## NORTH AFRICA

EGYPT  
MOROCCO  
TUNISIA  
ALGERIA  
LIBYA

## ASSIA

RUSSIA	INDIA
AZERBAIJAN	MALAYSIA
TURKMENISTAN	PAKISTAN
UZBEKISTAN	BANGLADESH
AFGHANISTAN	PHILIPPINES
KAZAKHSTAN	HONG KONG
KYRGYZSTAN	ARMENIA
TAIKISTAN	GEORGIA

## AMERICA

USA	HAITI
CANADA	MARTINIQUE
PANAMA	GUYANA
CHILE	FRENCH GUIANA

## EUROPE

GERMANY	UKRAINE	MALTA
FRANCE	POLAND	BELARUS
UK	PORTUGAL	
IRELAND	DENMARK	
ITALY	NORWAY	
SPAIN	MOLDOVA	
AUSTRIA	CZECH REPUBLIC	
NETHERLANDS	SLOVAKIA	
BELGIUM	LATVIA	

## BALKANS

TÜRKİYE	CROATIA
BOSNIA	ALBANIA
BULGARIA	GREECE
ROMANIA	SERBIA
KOSOVO	SLOVENIA
MACEDONIA	MONTENEGRO

## MIDDLE EAST

SAUDI ARABIA	BAHRAIN
KUWAIT	YEMEN
QATAR	LEBANON
UAE	JORDAN
OMAN	CYPRUS
IRAQ	KKTC



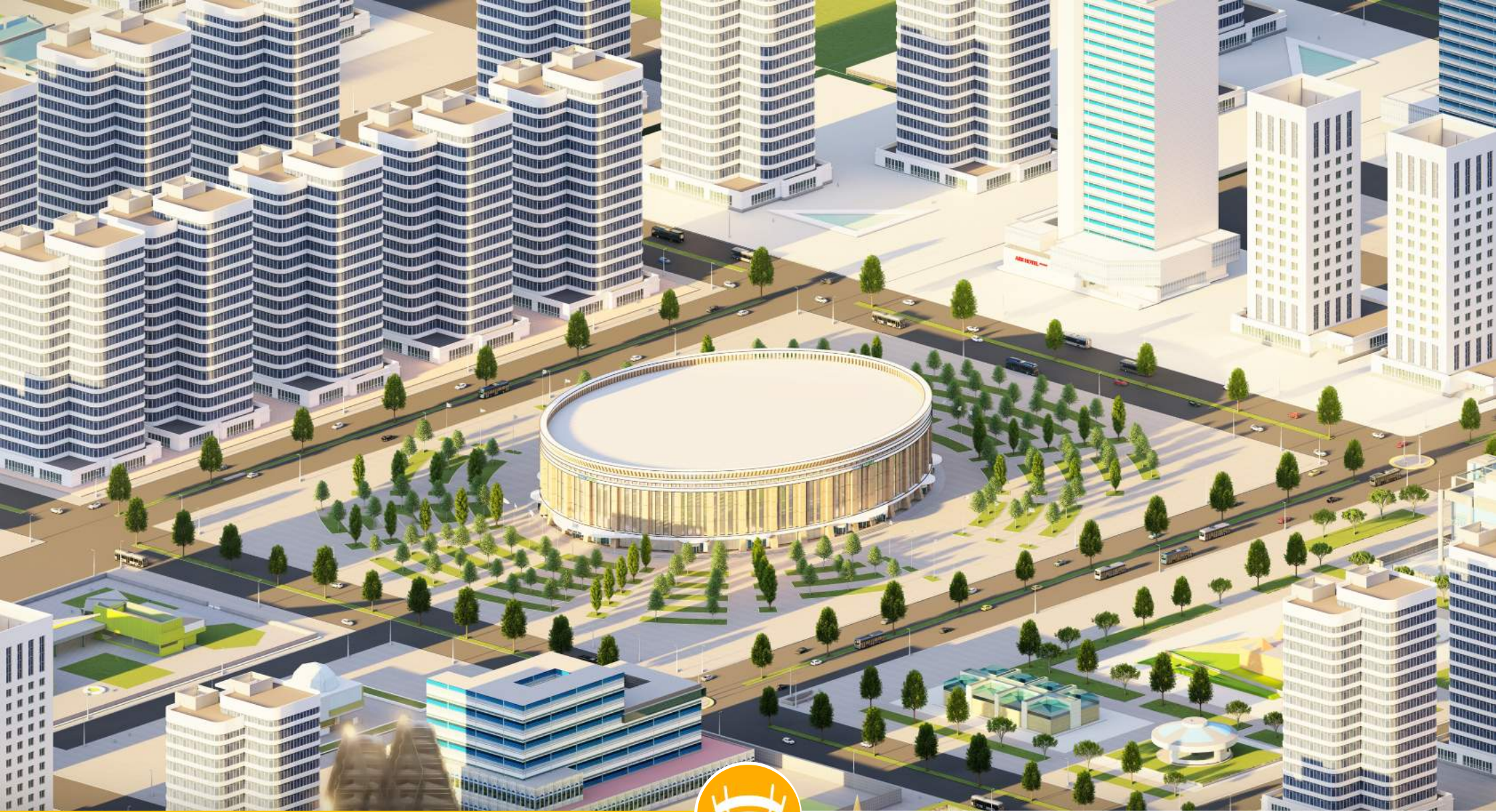

**13.000 SEATS  
INDOOR SPORTS ARENA**





# ▶ INDOOR SPORTS ARENA

- Basketball playgrounds in accordance with the FIBA standards.
- Large circulation area that can accommodate the general public.
- Interiors conforming to FIBA standards, cafes and offices.





# INDOOR SPORTS ARENA

- 1 INDOOR SPORTS ARENA
- 2 CAR PARK AREA
- 3 ENTRANCE AND LANDSCAPING AREA







REFORM SPORTS

BBB ARENA



# INDOOR SPORTS ARENA



[reformsports.com](https://reformsports.com)



[info@reformsports.com](mailto:info@reformsports.com)



+90 212 533 70 73



# INDOOR SPORTS ARENA

## TECHNICAL SPECIFICATIONS

- 17.000 m2 Total construction area
- 13.000 m2 Indoor area
- 1.500 m2 Parquet Floor, FIBA standards.
- 420 m2 Basketball Court, FIBA standards.
- 13.000 seating capacity
- 120 VIP Tribunes,
- 10 Protocol Tribunes
- 20 Locas
- Goal posts and nets
- Basketball Hoopa
- Substitute players bench
- Medical staff bench
- Center lighting system
- Led scoreboard
- Fire sytem
- Emergency announcement system
- Car park area for 100 car
- Center system sound system (Optional)

## LIVING AREAS

- Cafeterias
- Fitness center
- Locker rooms
- Referee locker rooms
- Public restrooms
- Disabled restrooms
- Observers and representatives rooms
- Meeting rooms
- Facility supervisor room
- Staff room
- Security rooms
- Offices
- UPS rooms
- Electricty room
- Securty camera system - (Optional)
- Card access system - (Optional)
- Generator - (Optional)

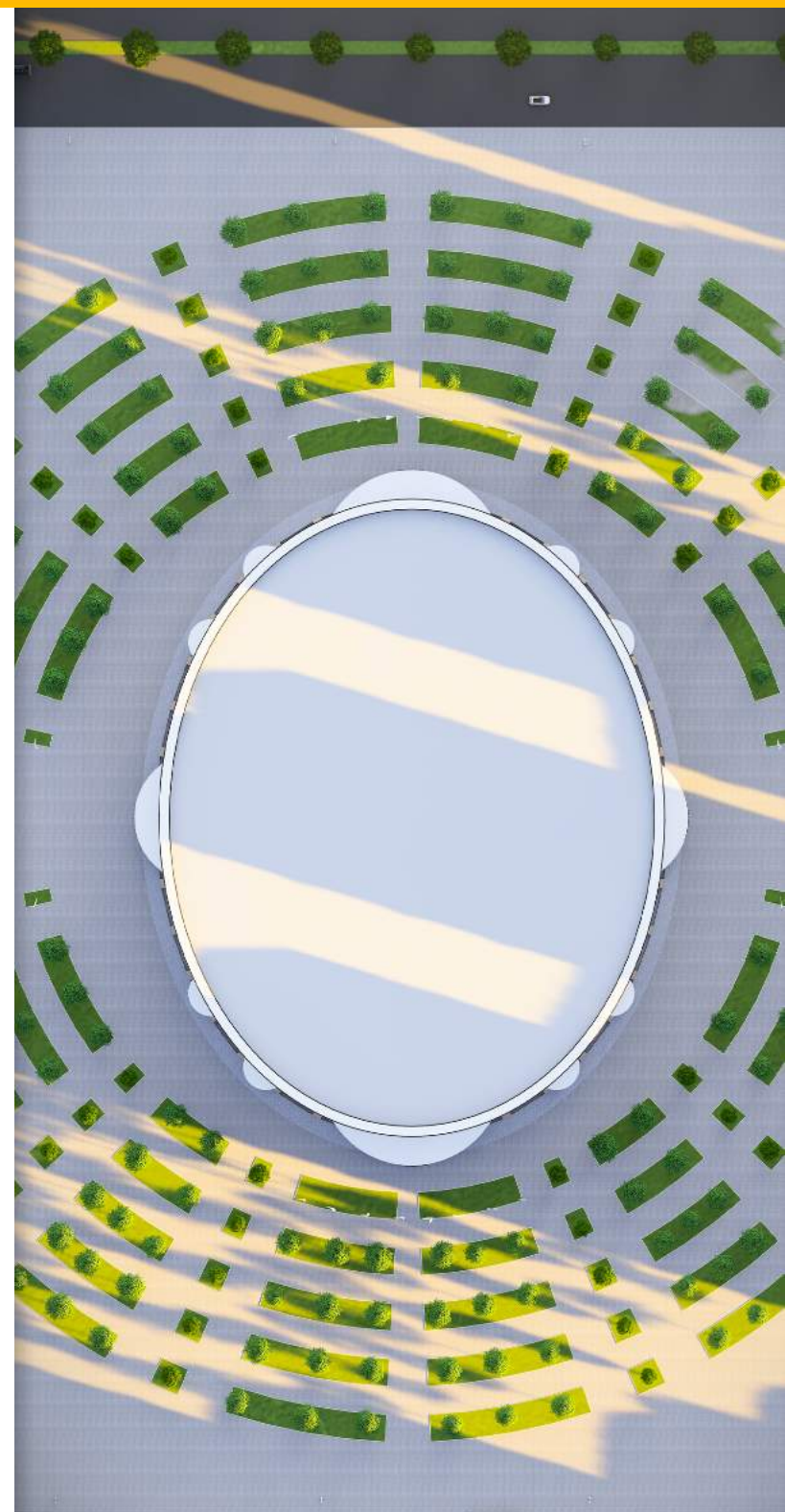



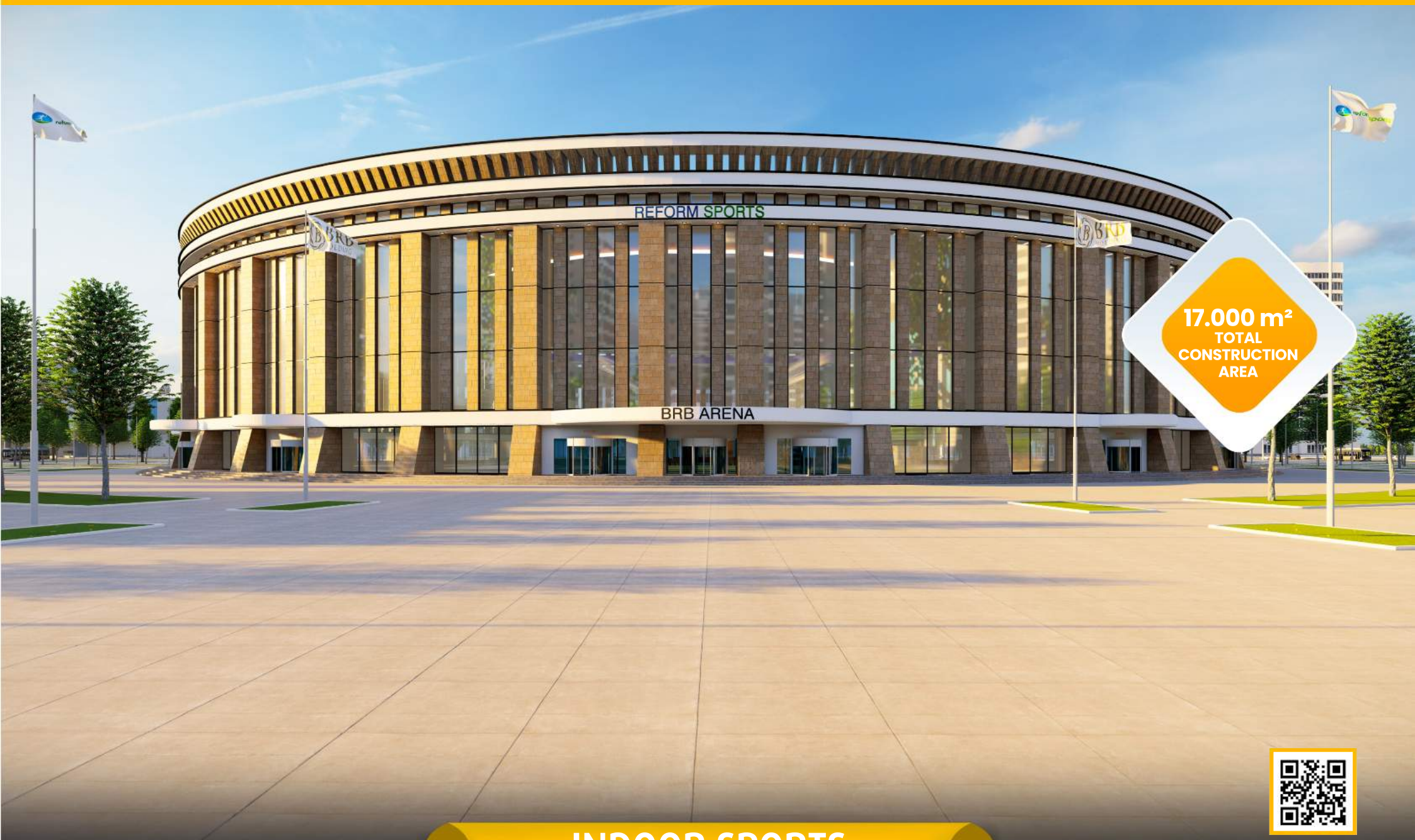

17.000 m<sup>2</sup>  
TOTAL  
CONSTRUCTION  
AREA

# INDOOR SPORTS ARENA



[reformsports.com](https://reformsports.com)



[info@reformsports.com](mailto:info@reformsports.com)



+90 212 533 70 73





13.000 m<sup>2</sup>  
INDOOR  
AREA



# INDOOR SPORTS ARENA

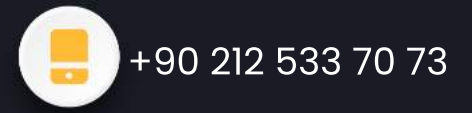





**ERGONOMIC  
DESIGN**



# INDOOR SPORTS ARENA



[reformsports.com](https://reformsports.com)



[info@reformsports.com](mailto:info@reformsports.com)



+90 212 533 70 73



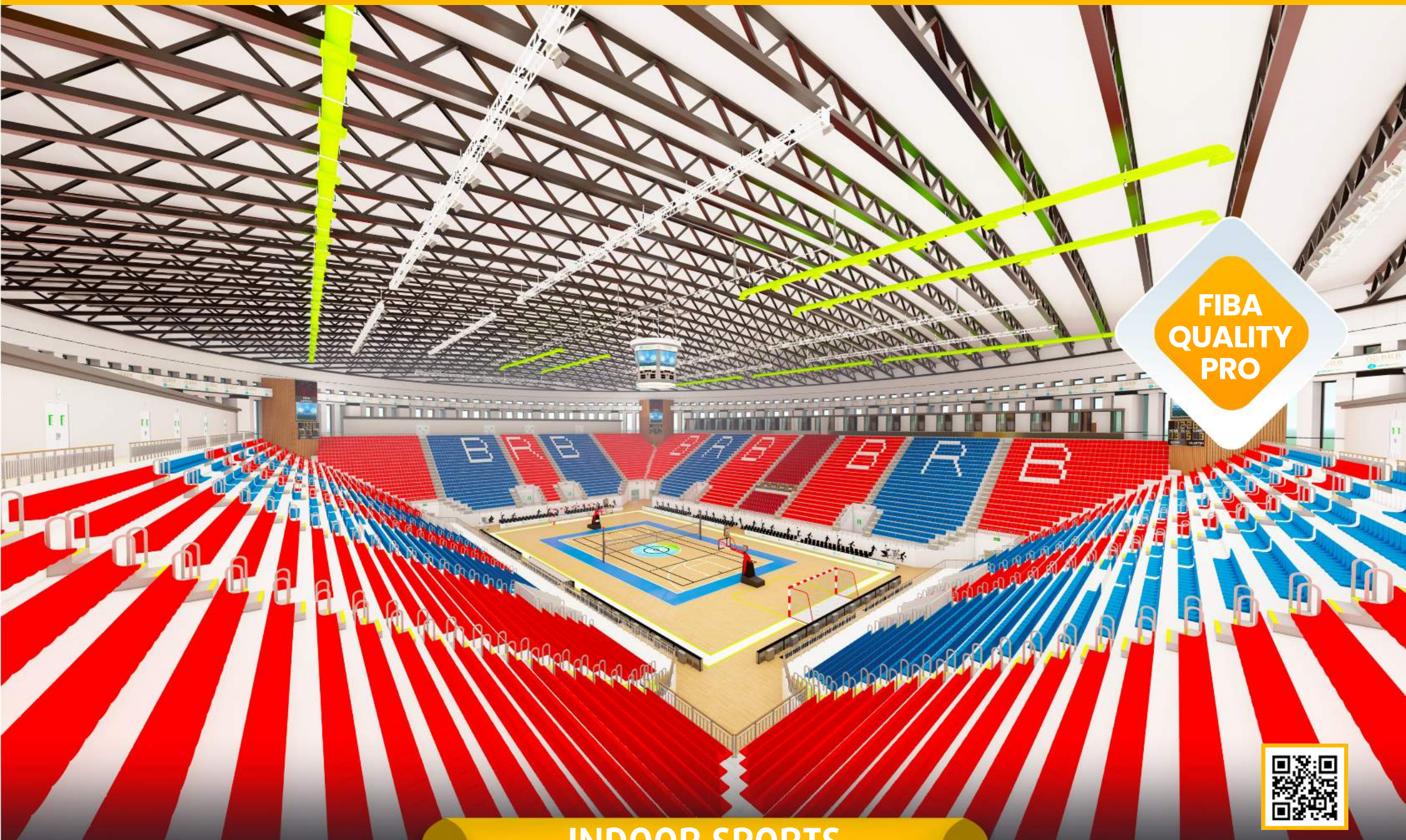

**FIBA  
QUALITY  
PRO**



# INDOOR SPORTS ARENA



[reformsports.com](https://reformsports.com)



[info@reformsports.com](mailto:info@reformsports.com)



+90 212 533 70 73



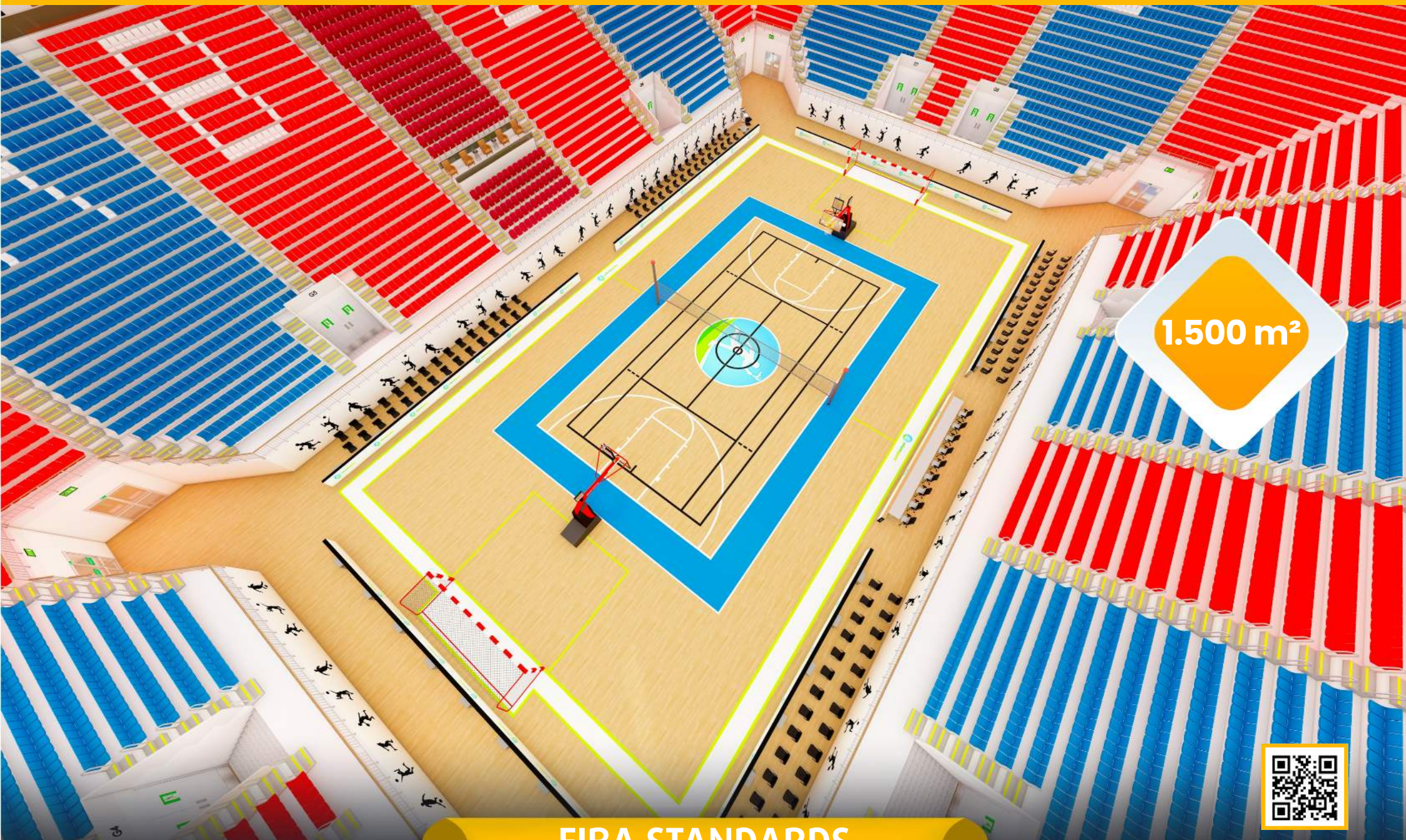

## FIBA STANDARDS PARQUET FLOOR



[reformsports.com](https://reformsports.com)



[info@reformsports.com](mailto:info@reformsports.com)



+90 212 533 70 73



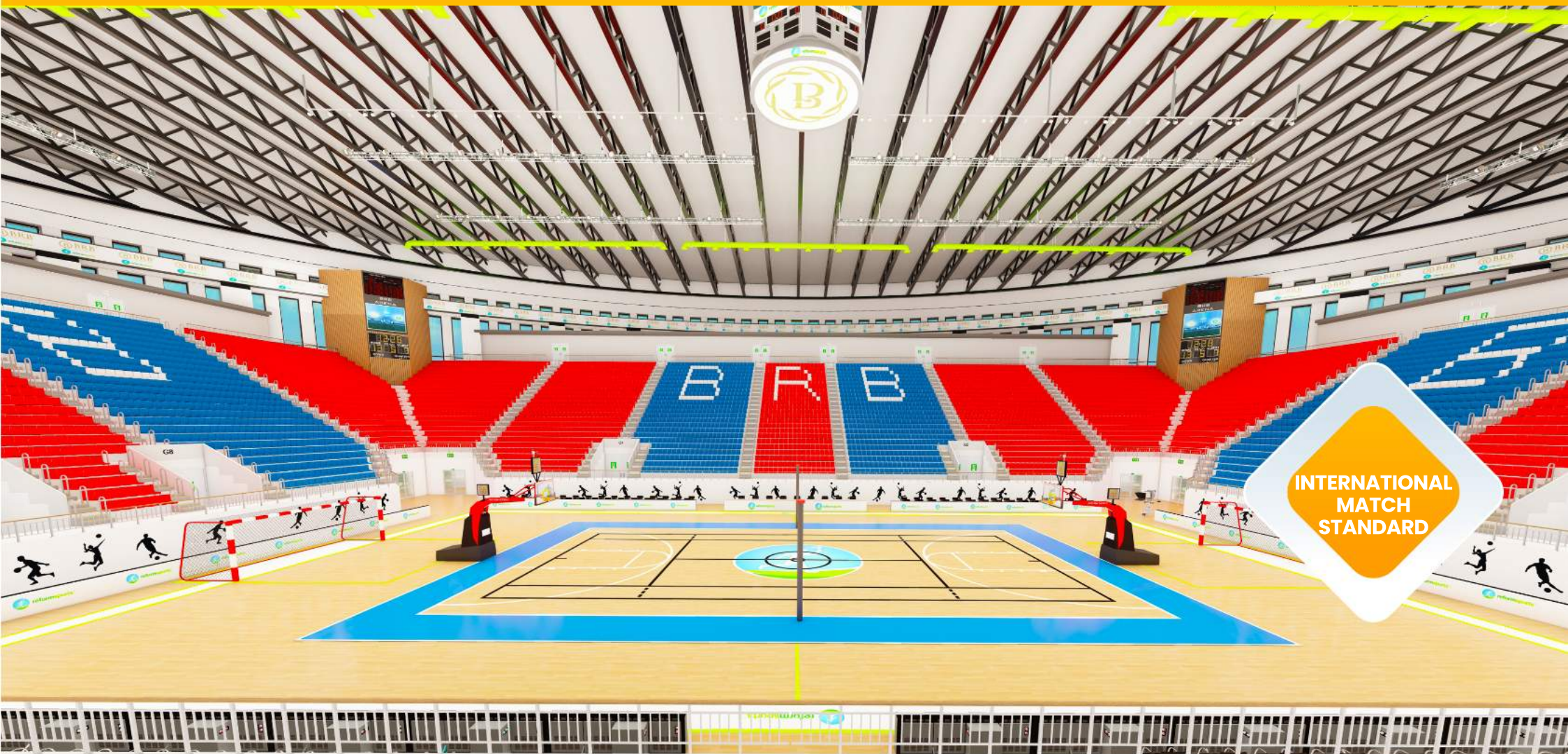

INTERNATIONAL  
MATCH  
STANDARD



## FIBA STANDARDS PARQUET FLOOR



[reformsports.com](https://reformsports.com)



[info@reformsports.com](mailto:info@reformsports.com)



+90 212 533 70 73



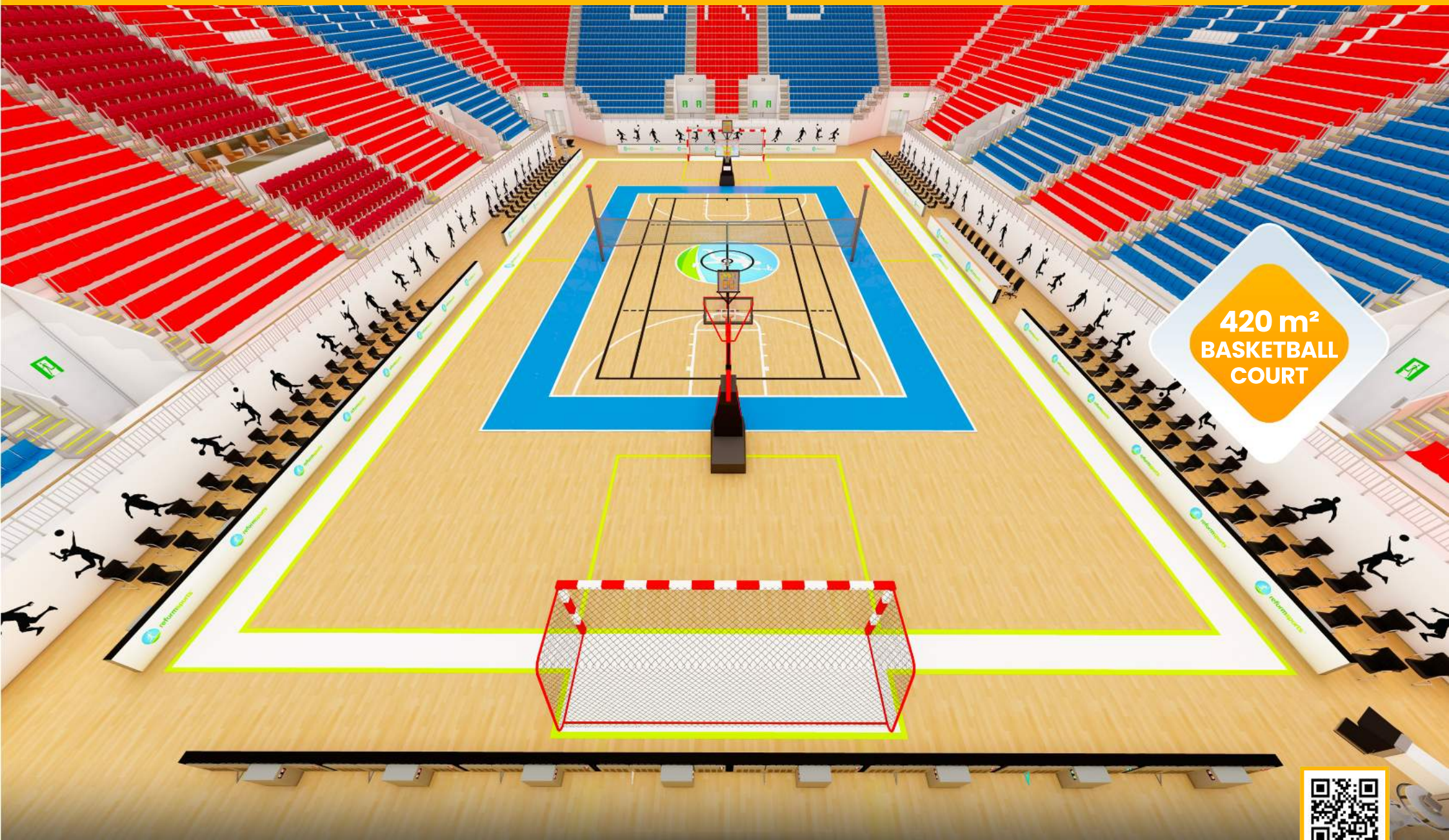

420 m<sup>2</sup>  
BASKETBALL  
COURT

FIBA STANDARDS  
PARQUET FLOOR

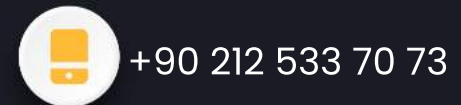
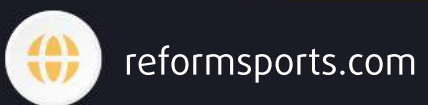



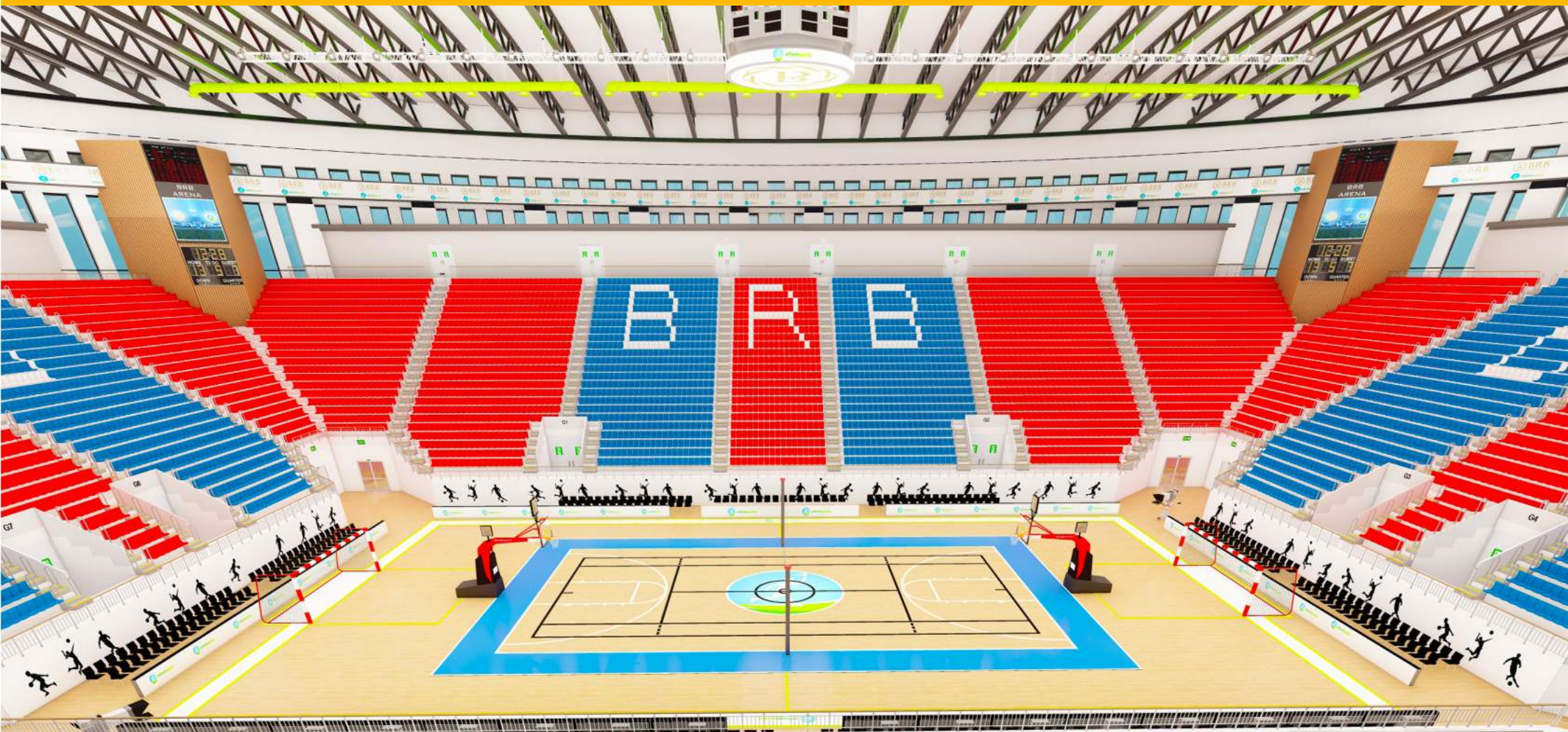

## FIBA STANDARDS PARQUET FLOOR



[reformsports.com](https://reformsports.com)



[info@reformsports.com](mailto:info@reformsports.com)



+90 212 533 70 73



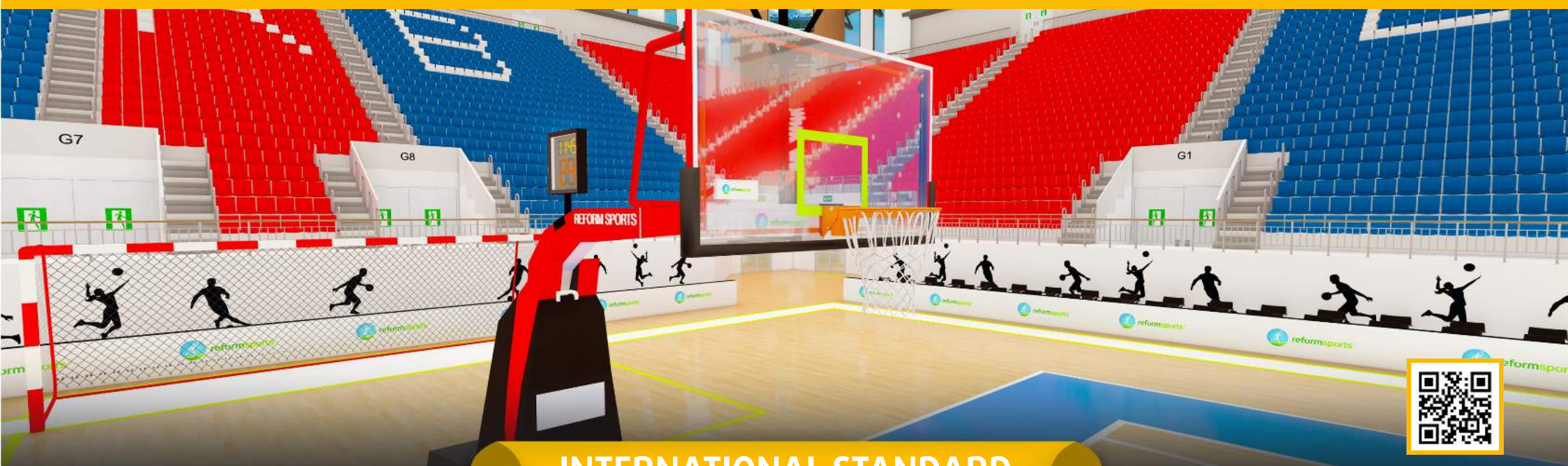
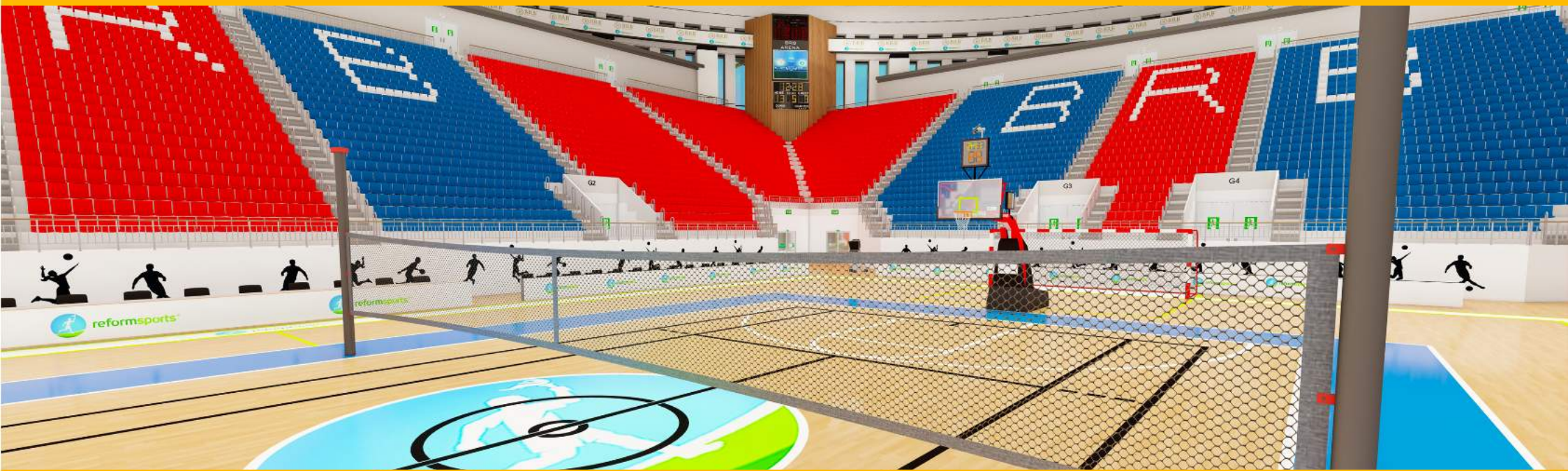

## INTERNATIONAL STANDARD EQUIPMENT



[reformsports.com](https://reformsports.com)



[info@reformsports.com](mailto:info@reformsports.com)



+90 212 533 70 73



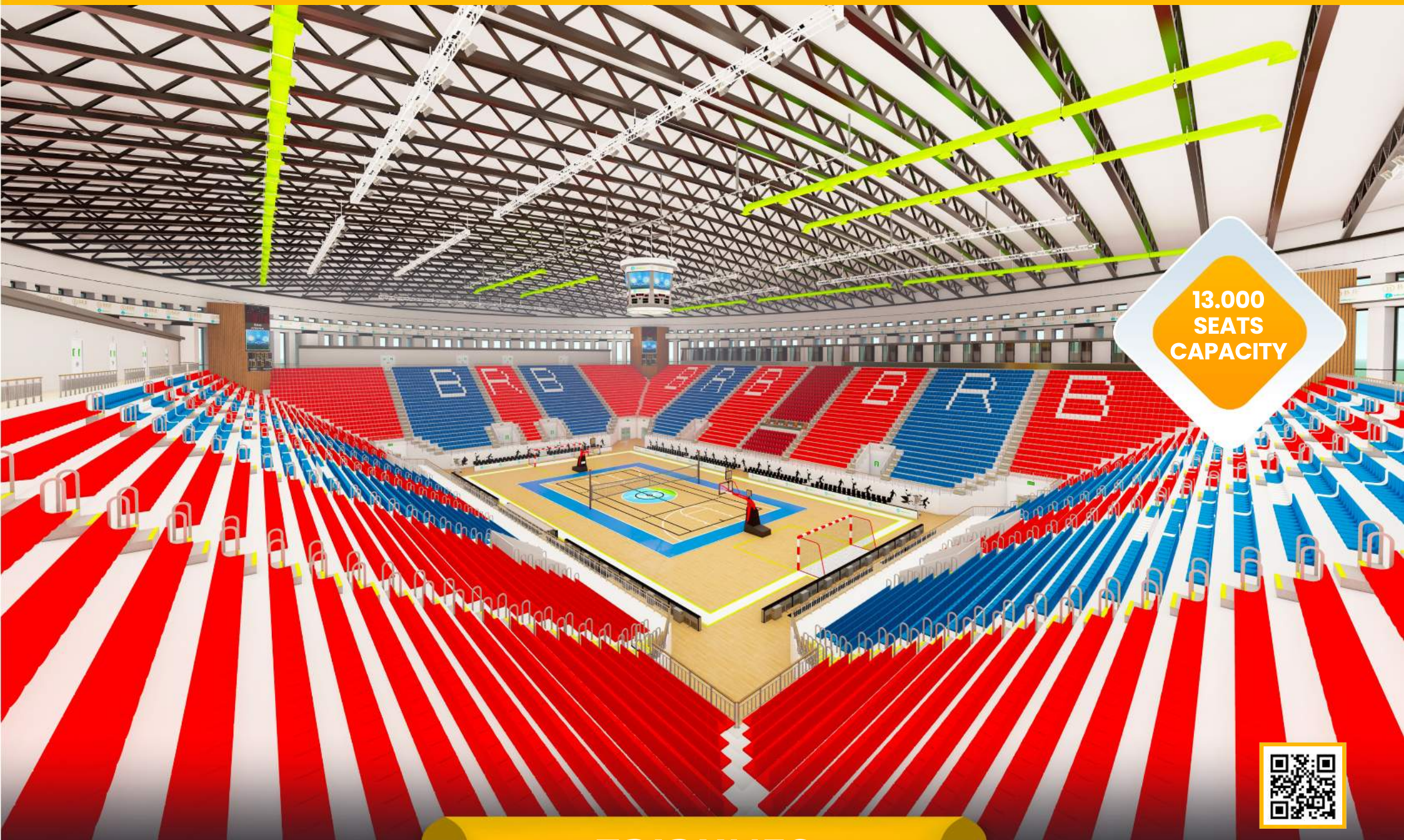

13.000  
SEATS  
CAPACITY



# TRIBUNES



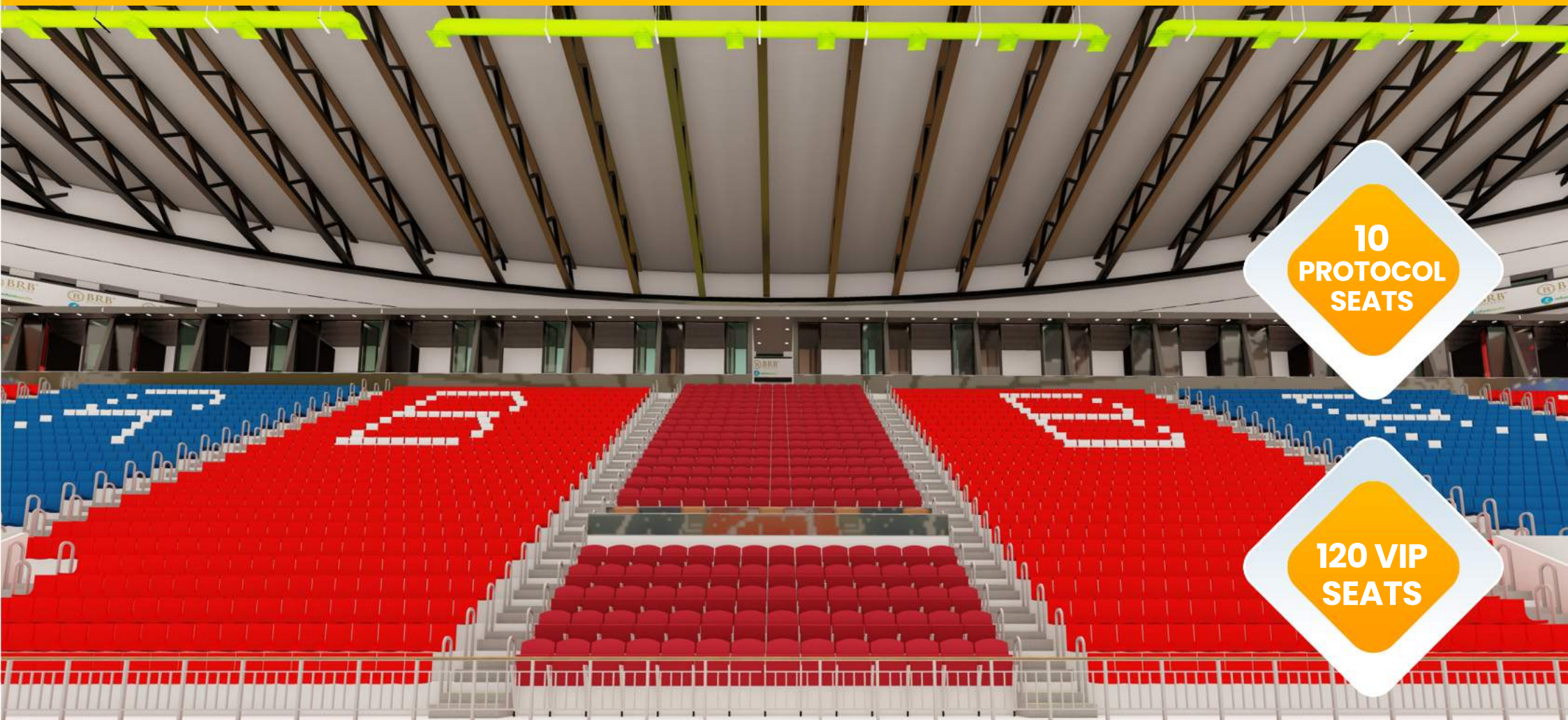

10  
PROTOCOL  
SEATS

120 VIP  
SEATS



## TRIBUNES



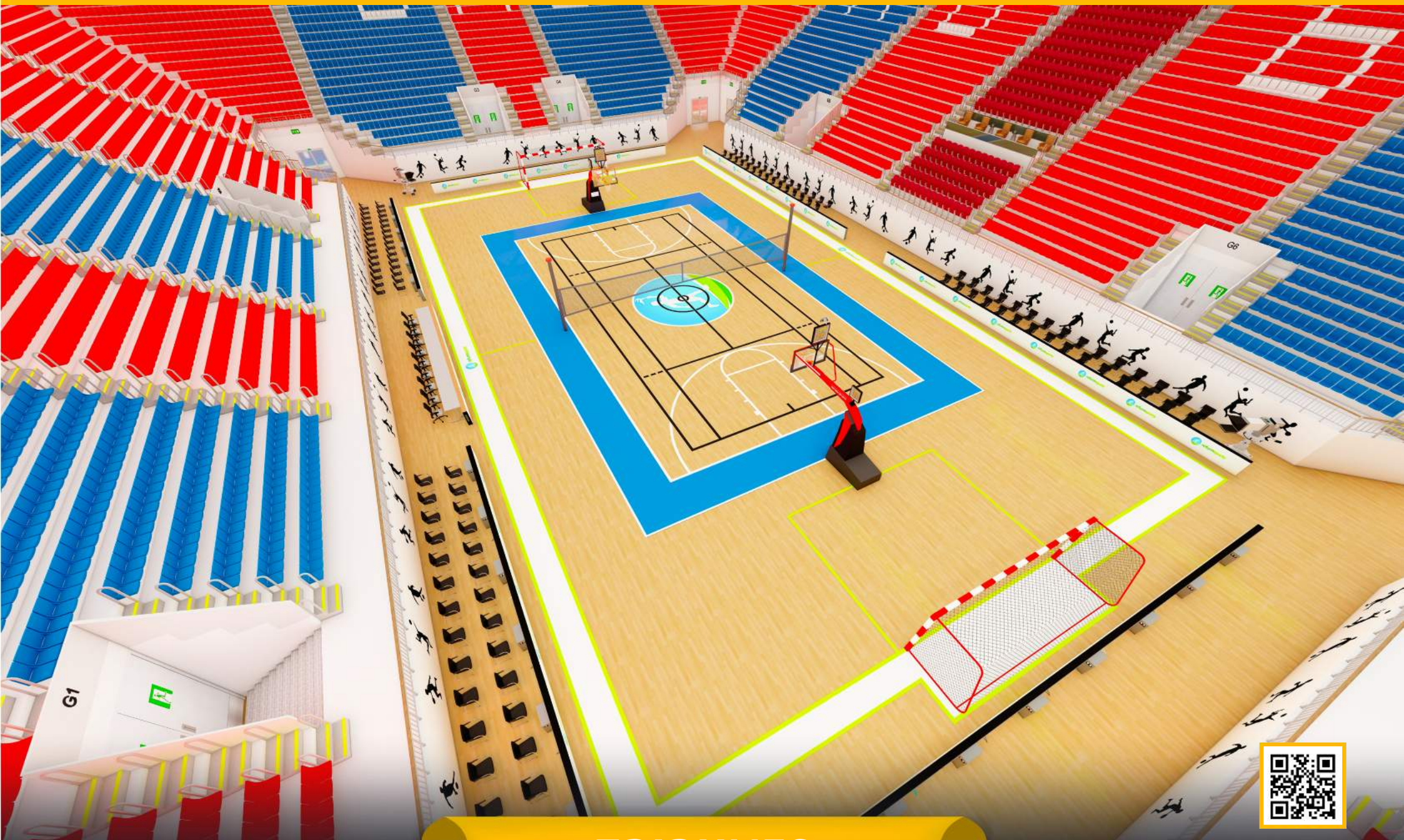

# TRIBUNES



[reformsports.com](https://reformsports.com)



[info@reformsports.com](mailto:info@reformsports.com)



+90 212 533 70 73



YOUR TEAM HERE

HOME	888	GUEST	888	PER	8	SHOT	88.88
TIME	88:88	HOME T.O.L	8	GUEST T.O.L	8		
EVENT	888	HEAT	888	LANE	PLACE	TIME	
88	88	88	88.88	88	88	88:88.88	
88	88	88	88.88	88	88	88:88.88	
88	88	88	88.88	88	88	88:88.88	
88	88	88	88.88	88	88	88:88.88	
88	88	88	88.88	88	88	88:88.88	
88	88	88	88.88	88	88	88:88.88	

# BRB ARENA



HOME TO GO GUEST

DOWN QUARTER



## HD+ SCREEN SCOREBOARD





# HD+ SCREEN SCOREBOARD



[reformsports.com](http://reformsports.com)



[info@reformsports.com](mailto:info@reformsports.com)



+90 212 533 70 73





## FIBA STANDARD LED LIGHTING SYSTEM



[reformsports.com](https://reformsports.com)



[info@reformsports.com](mailto:info@reformsports.com)



+90 212 533 70 73





## ENTRANCE AND TOLLS



[reformsports.com](https://www.reformsports.com)



[info@reformsports.com](mailto:info@reformsports.com)



+90 212 533 70 73





120 M<sup>2</sup>  
FOR  
TEAMS



# LOCKER ROOMS



[reformsports.com](https://reformsports.com)



[info@reformsports.com](mailto:info@reformsports.com)



+90 212 533 70 73





## TOILETS AND BATHROOMS



[reformsports.com](https://reformsports.com)



[info@reformsports.com](mailto:info@reformsports.com)



+90 212 533 70 73





## REFEREE ROOM

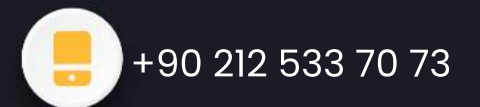





100 m<sup>2</sup>



# FITNESS CENTER



[reformsports.com](https://reformsports.com)



[info@reformsports.com](mailto:info@reformsports.com)



+90 212 533 70 73





## MEETING ROOM



[reformsports.com](https://reformsports.com)



[info@reformsports.com](mailto:info@reformsports.com)



+90 212 533 70 73



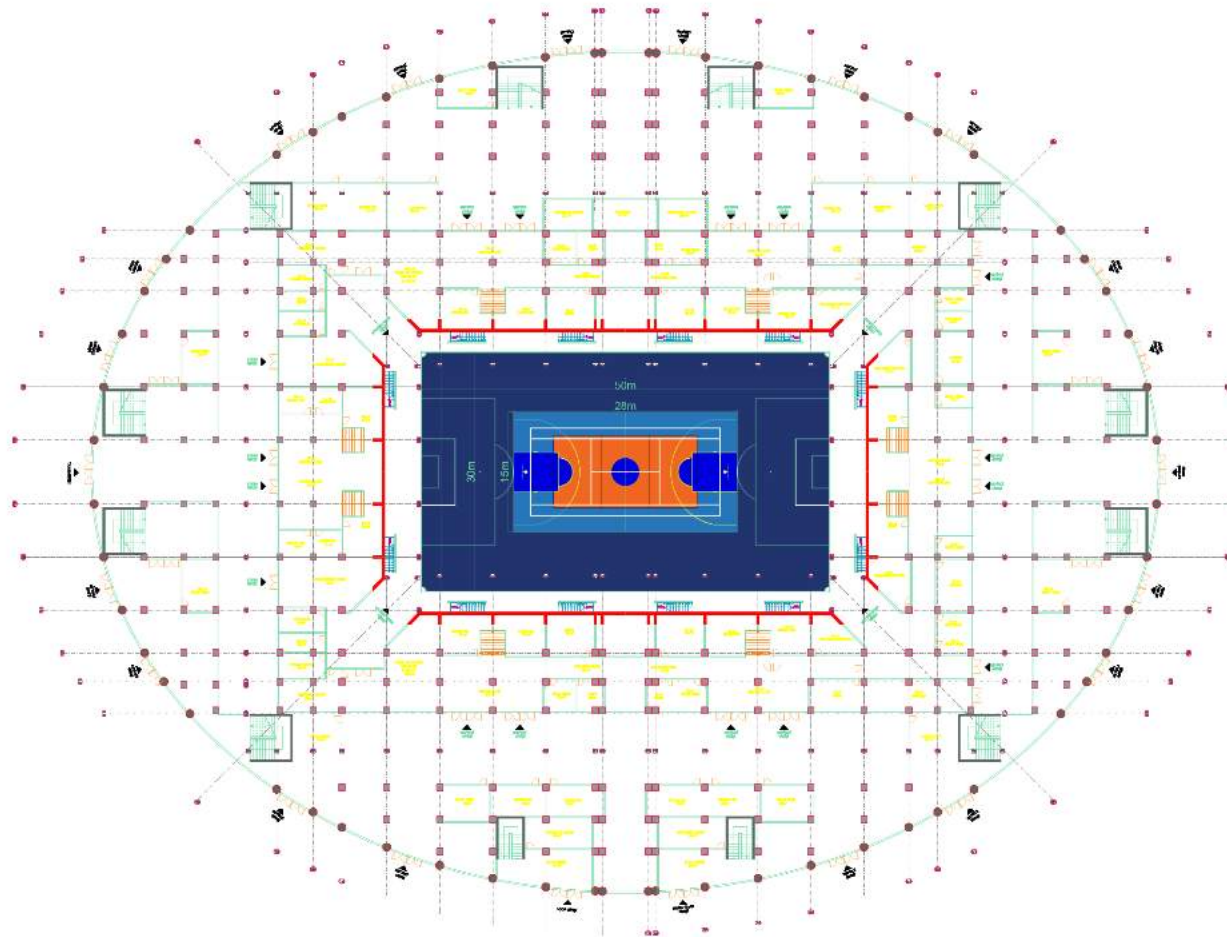

# GROUND FLOOR ARCHITECTURAL PLAN





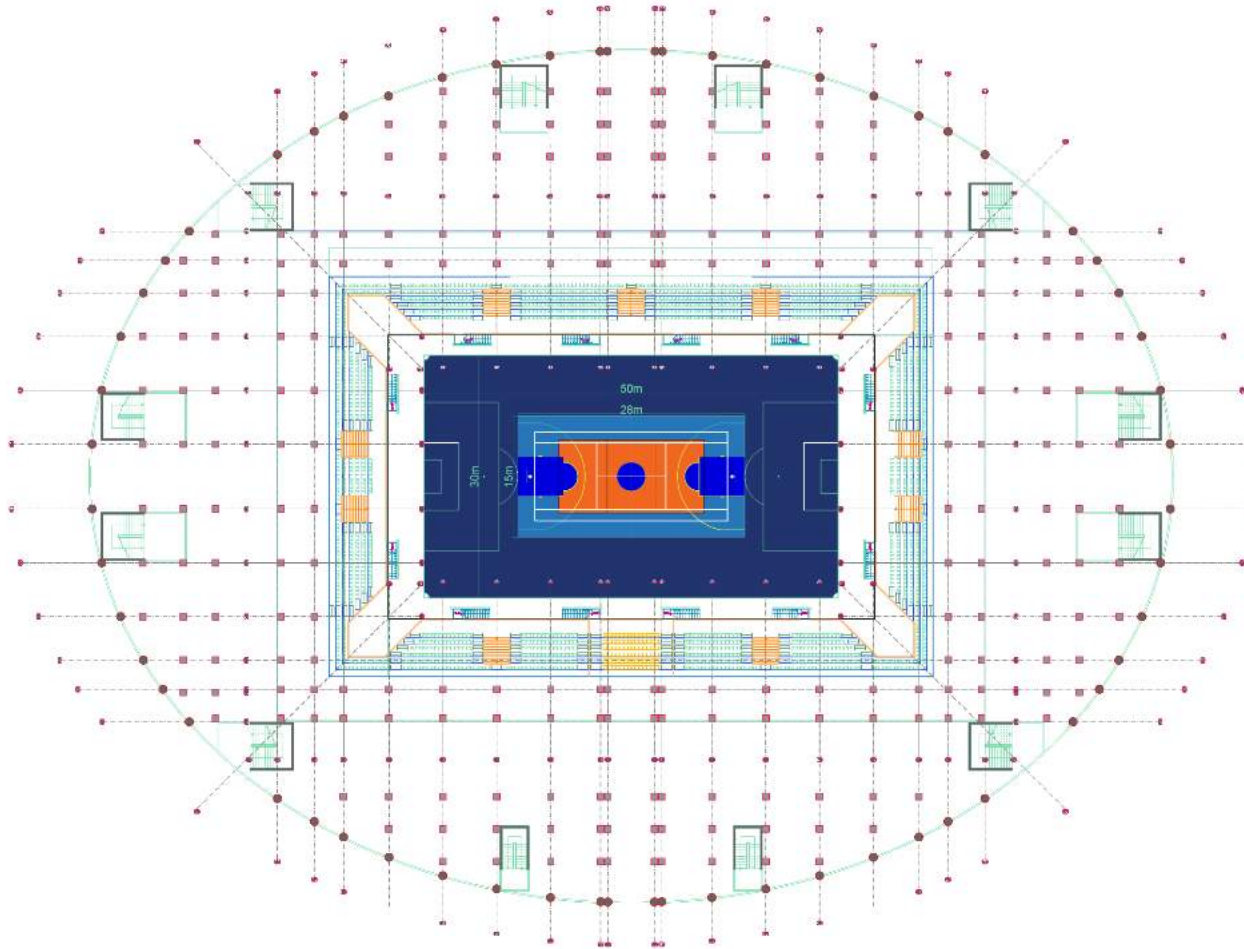

# FIRST FLOOR ARCHITECTURAL PLAN





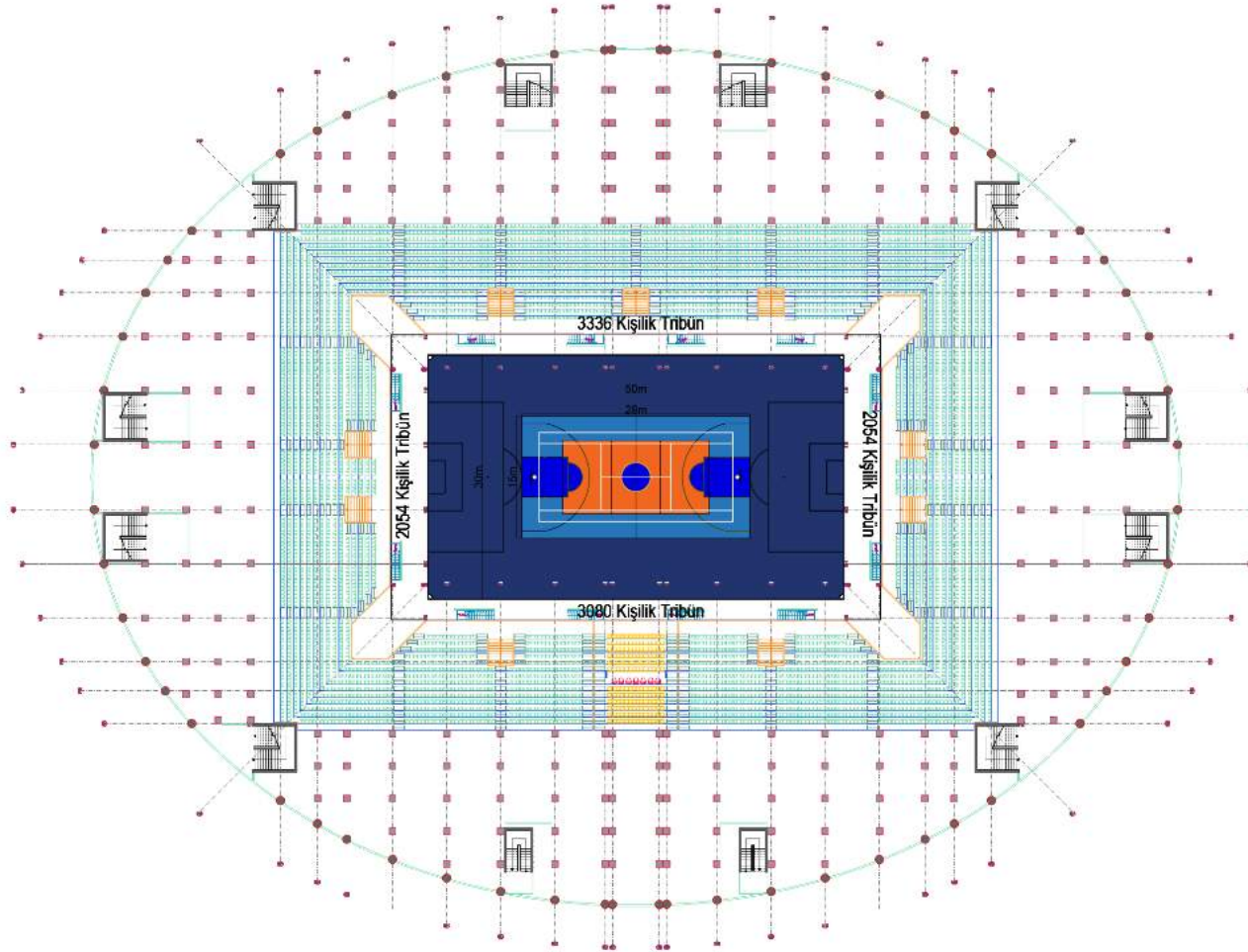

# SECOND FLOOR ARCHITECTURAL PLAN





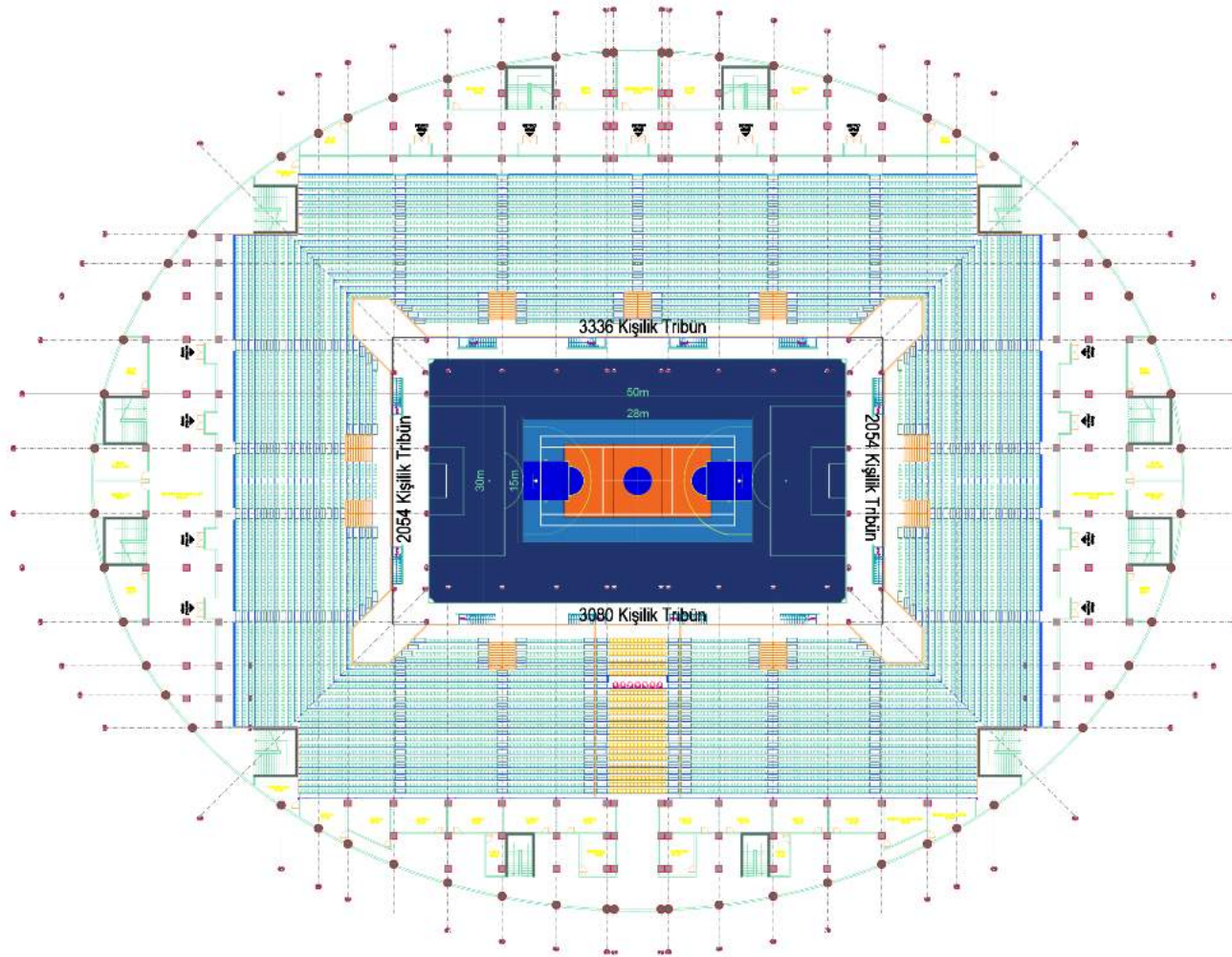

# THIRD FLOOR ARCHITECTURAL PLAN







reform<sup>®</sup>  
sports



[www.reformsports.com](http://www.reformsports.com)