



reform[®]
sports

15.000 Seats Stadium



HEADQUARTER - İSTANBUL/TÜRKİYE

REFORM SPORTS



[reformsports.com](https://www.reformsports.com)



info@reformsports.com



+90 212 533 70 73



FACTORY

TEKİRDAĞ/TÜRKİYE

TURF PRODUCTION CAPACITY 11.000.000 M² / YEAR •

RUBBER PRODUCTION CAPACITY 300.000 M² / YEAR •

STEEL CONSTRUCTION CAPACITY 12.000 TON / YEAR •

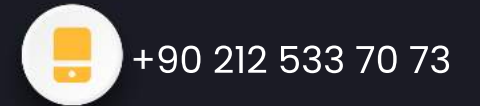

○ WE ARE LEADING ○

- **STADIUMS**
- **SPORTS ARENA**
- **TURN-KEY SPORTS COMPLEXES**
- **FIFA FOOTBALL FIELDS**
- **PROFESSIONAL FOOTBALL FIELDS**
- **HYBRID TURF FOOTBALL FIELDS**
- **ATHLETICS TRACKS**
- **METAL CONSTRUCTION**
- **INDOOR SPORTS COMPLEXES**
- **OUTDOOR SPORTS COMPLEXES**
- **PADEL COURTS**
- **FOOT 5 COURTS**
- **BASKETBALL, VOLLEYBALL, HANDBALL, TENNIS COURT**
- **HOCKEY, CRICKET FIELDS**
- **GOLF COURSES**
- **MULTISPORT FLOORING**
- **LANDSCAPING**
- **CHILDREN PLAY GROUNDS**

WHY REFORM SPORTS?

- OVER 30 YEARS OF EXPERIENCE
- TURN-KEY SOLUTIONS
- FLEXIBILITY AND FAST DELIVERY
- ENVIRONMENTALLY FRIENDLY
- RECYCLABLE MATERIALS
- HIGH QUALITY AND COMPETITIVE PRICES
- WARRANTY AND DURABILITY
- INTERNATIONALLY CERTIFIED

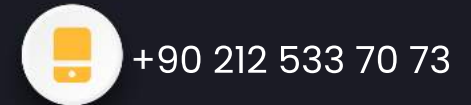
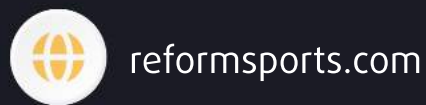



BRB
HOLDING

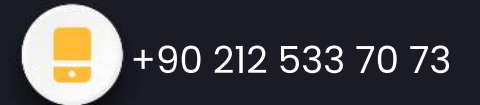

HIGHEST QUALITY

CERTIFIED BY INTERNATIONAL AUTHORITIES





7
REGIONS

105
COUNTRIES

15.000
PROJECTS



AFRICA

NIGERIA	NIJER	ETHIOPIA	SOUTH SUDAN
GANA	SIERRA LEONE	KENYA	MAURITIUS
SENEGAL	DEM. REP. OF CONGO	UGANDA	
IVORY COAST	CAMEROON	TANZANIA	
GAMBIA	KONGO	RWANDA	
MALI	GABON	MOZAMBIQUE	
GUINEA	CHAD	BURUNDI	
MAURITANIA	SOUTH AFRICA	DJIBOUTI	
BURKINA FASO	ZAMBIA	SOMALIA	
TOGO	SUDAN		

NORTH AFRICA

EGYPT
MOROCCO
TUNISIA
ALGERIA
LIBYA

ASSIA

RUSSIA	INDIA
AZERBAIJAN	MALAYSIA
TURKMENISTAN	PAKISTAN
UZBEKISTAN	BANGLADESH
AFGHANISTAN	PHILIPPINES
KAZAKHSTAN	HONG KONG
KYRGYZSTAN	ARMENIA
TAIIKISTAN	GEORGIA

AMERICA

USA	HAITI
CANADA	MARTINIQUE
PANAMA	GUYANA
CHILE	FRENCH GUIANA

EUROPE

GERMANY	UKRAINE	MALTA
FRANCE	POLAND	BELARUS
UK	PORTUGAL	
IRELAND	DENMARK	
ITALY	NORWAY	
SPAIN	MOLDOVA	
AUSTRIA	CZECH REPUBLIC	
NETHERLANDS	SLOVAKIA	
BELGIUM	LATVIA	

BALKANS

TÜRKİYE	CROATIA
BOSNIA	ALBANIA
BULGARIA	GREECE
ROMANIA	SERBIA
KOSOVO	SLOVENIA
MACEDONIA	MONTENEGRO

MIDDLE EAST

SAUDI ARABIA	BAHRAIN
KUWAIT	YEMEN
QATAR	LEBANON
UAE	JORDAN
OMAN	CYPRUS
IRAQ	KKTC

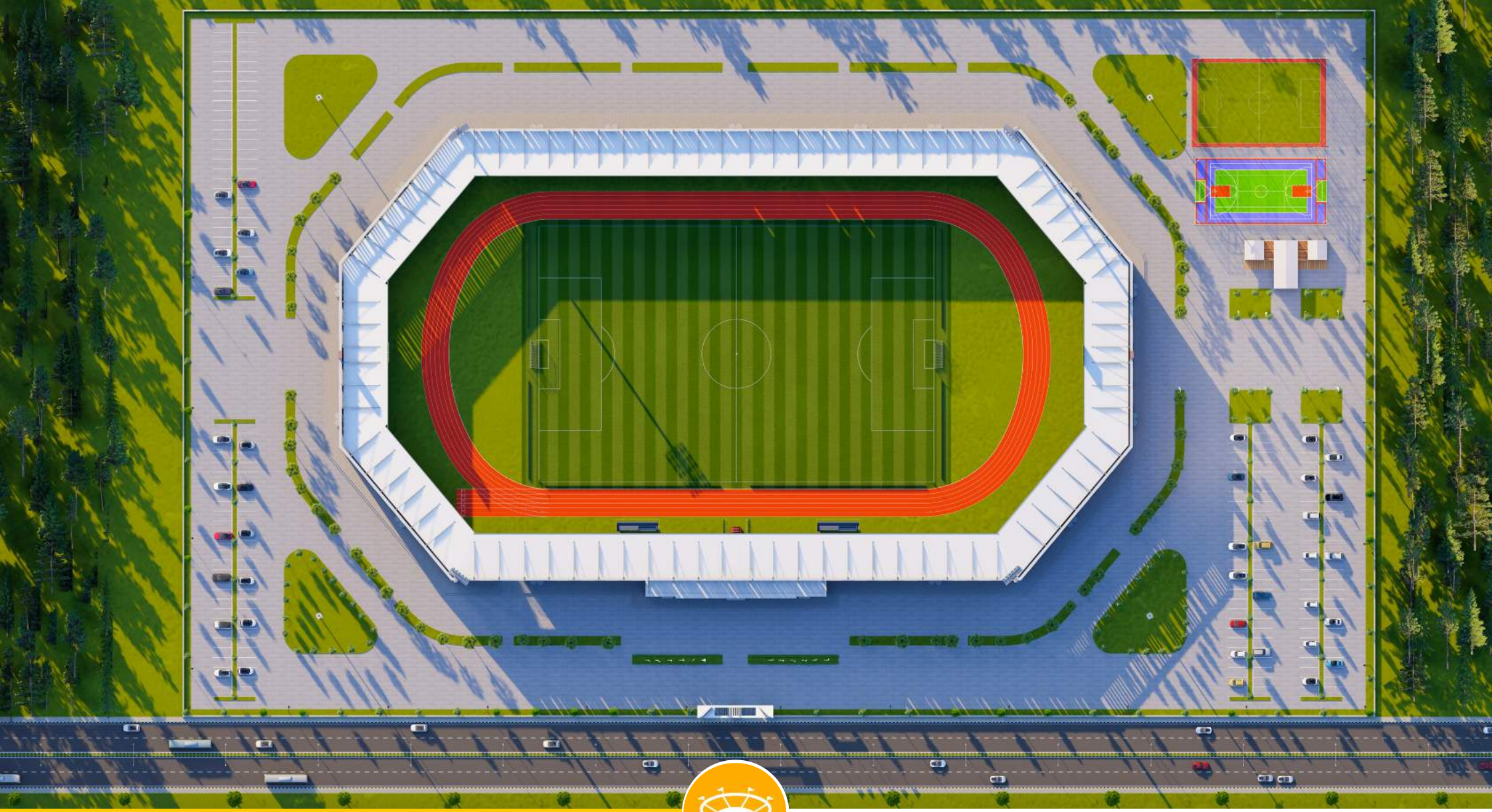

15.000 SEATS STADIUM



▶ STADIUM

- Football and athletics playgrounds in accordance with the FIFA and World Athletics standards.
- Large circulation area on the ground floor that can accommodate the general public.
- Covered Tribunes, technical rooms, cafes and offices.



STADIUM

- 1 STANDARD FOOTBALL FIELD
- 2 ATHLETICS TRACK
- 3 TRIBUNES
- 4 MULTI-PURPOSE SPORTS FIELD
- 5 FOOTBALL TRAINING FIELD





STADIUM

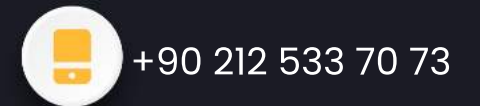

STADIUM

TECHNICAL SPECIFICATIONS

- 27.000m2 Total construction area
- 2.500m2 indoor construction area
- 7.140m2 FIFA standards football field
- 3.500 m2 Sandwich system running track
- 15.000 seating capacity roofed tribunes
- 200 VIP Tribunes,
- 13 Protocol Tribunes
- 10 Pcs. Loca
- Goal post and nets
- Corner poles
- Substitute benches
- Referee bench
- Ligthing system
- Led Score Board
- Fire system
- Emergency alert system
- Car parking area for 100 cars
- Sound system (Optional)

LIVING AREAS

- Cafeterias
- Fitnes center
- Locker rooms
- Referee locker rooms
- Public restrooms
- Disbaled restrooms
- Observers and representatives rooms
- Meeting rooms
- Facility supervisor room
- Staff rooms
- Security rooms
- Offices
- UPS room
- Electriciry controlling room
- Camera System (Optional)
- Card access control system (Optional)
- Generator (Optional)



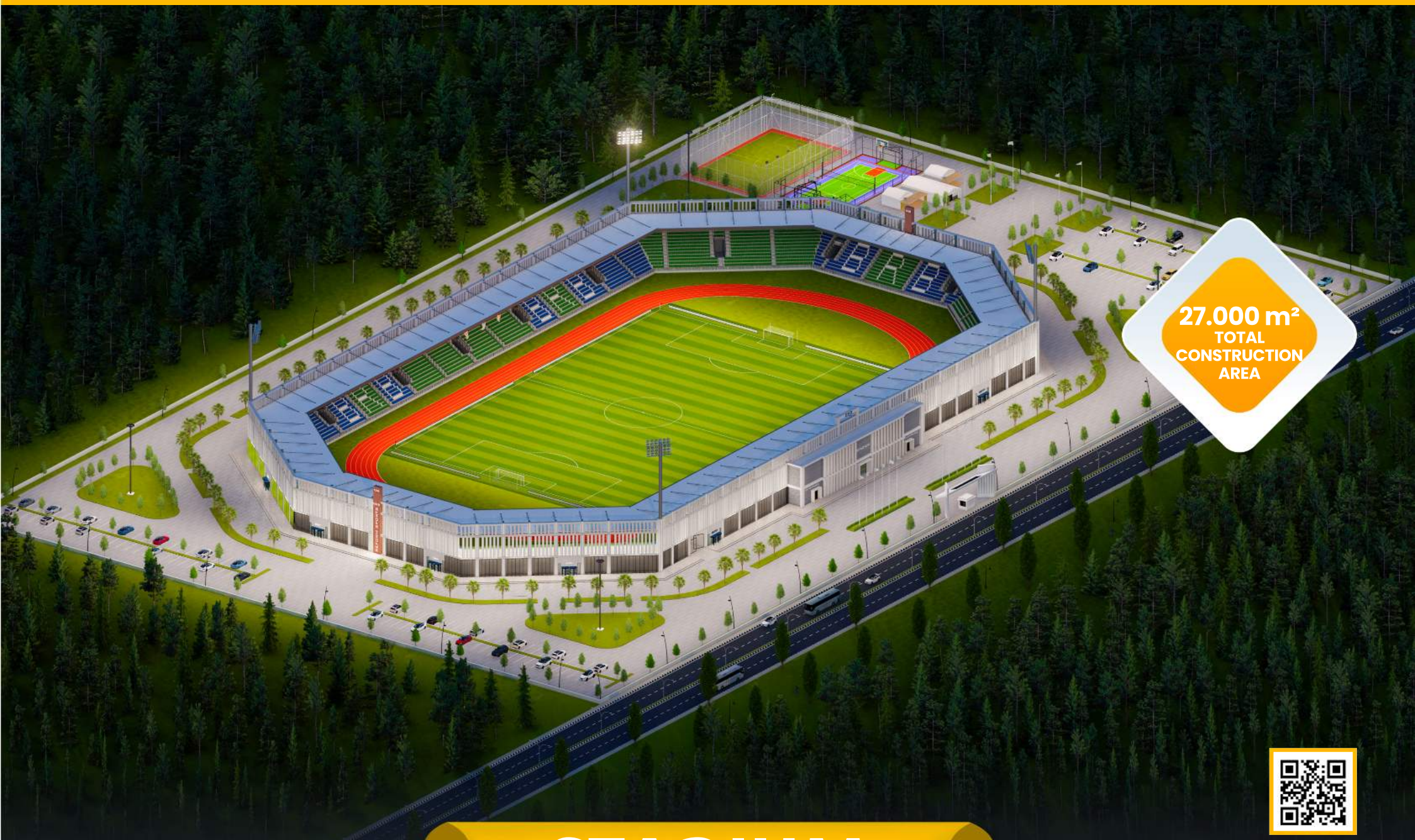

27.000 m²
TOTAL
CONSTRUCTION
AREA



STADIUM



reformsports.com



info@reformsports.com



+90 212 533 70 73



STADIUM

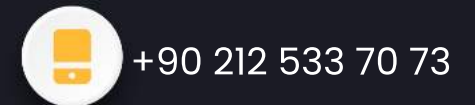
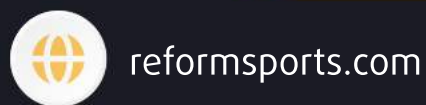



STADIUM



reformsports.com



info@reformsports.com



+90 212 533 70 73



FIFA
QUALITY
PRO



STANDARD FOOTBALL FIELD



reformsports.com



info@reformsports.com



+90 212 533 70 73

High Quality

Our products are produced with the highest quality, ethical standards and in accordance with the international standards



Resistant

Our abrasion and wear resistant products come with different heights, colour options and unique characteristics



Long Lasting

Artificial turfs are easy to maintain and cheap, as well as have a very long life with low maintenance



REFORM SPORTS' synthetic turf is produced with new generation monofilament yarns provides high-quality and provides maximum-performance for training and professional football pitches. Delays wear and tear due to modern yarn design and features. For many years; ball roll and bouncing and shock absorbing values remain in accordance with international standards. It doesn't reduce player's performance, it is environmentally friendly and recyclable.

ARTIFICIAL GRASS



Natural Appearance

It is produced with monofilament yarns for aesthetic and more natural appearance



High UV Resistance

It is produced with special UV resistant additive. Besides being resistant to UV rays, it is also resistant to cold weather



Nature Friendly

Our products are manufactured with environmental awareness and consist of recyclable materials with the use of effective technology and com-
pone



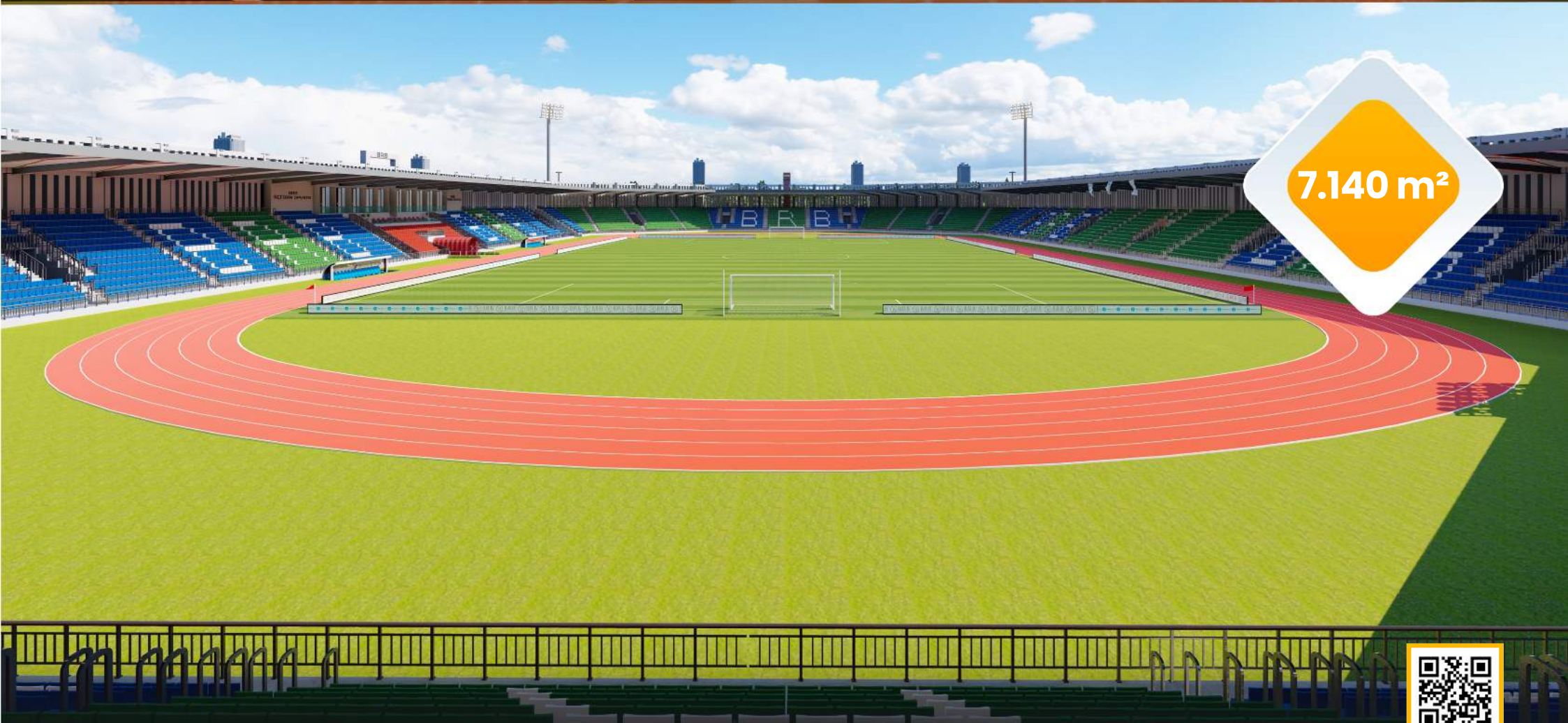

7.140 m²



STANDARD FOOTBALL FIELD



reformsports.com



info@reformsports.com



+90 212 533 70 73

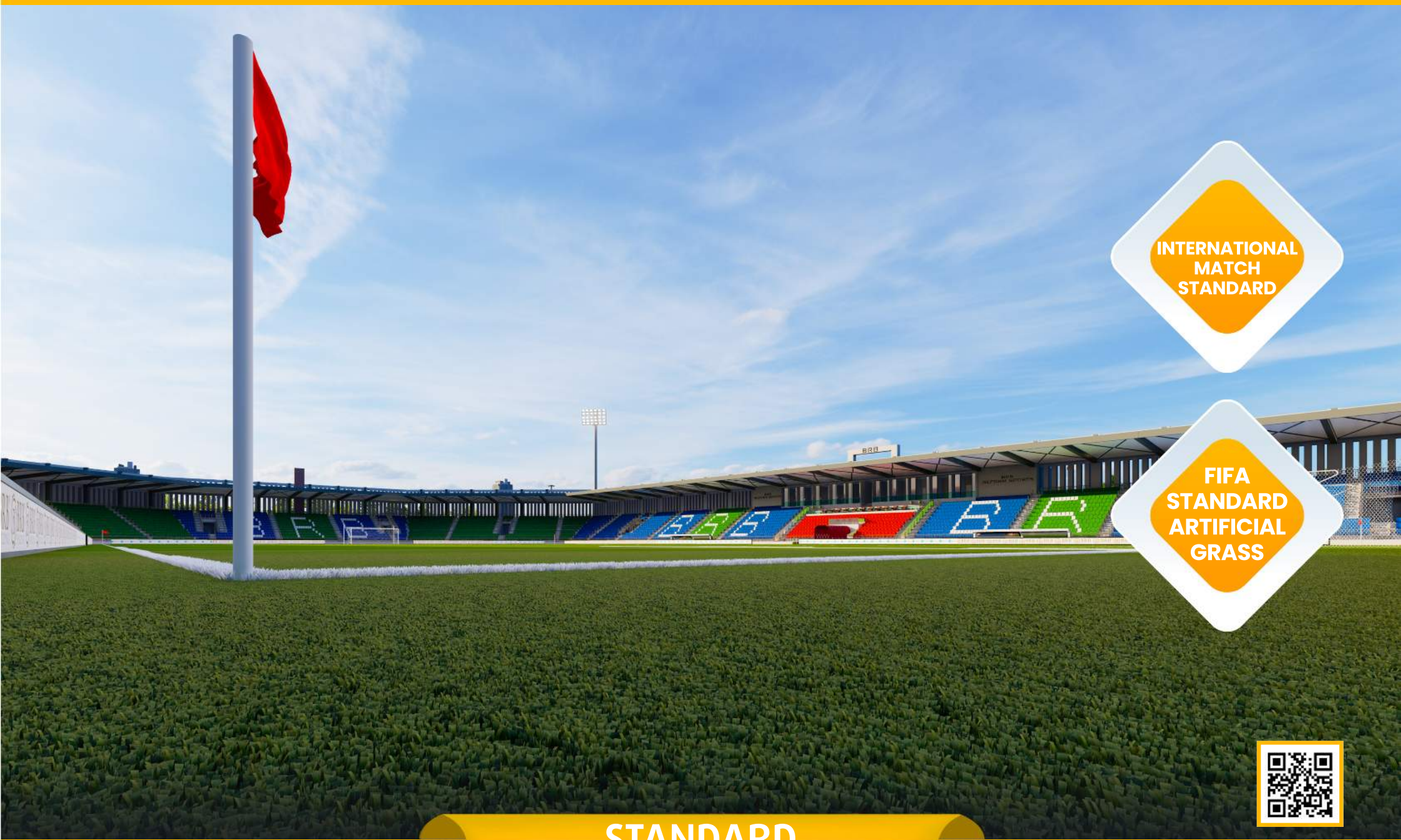

**INTERNATIONAL
MATCH
STANDARD**

**FIFA
STANDARD
ARTIFICIAL
GRASS**



**STANDARD
FOOTBALL FIELD**



reformsports.com



info@reformsports.com



+90 212 533 70 73



WORLD
ATHLETICS
FEDERATION
CERTIFIED
ATHLETICS
TRACK



ATHLETICS TRACK



reformsports.com



info@reformsports.com



+90 212 533 70 73

High Quality

Our products are produced with the highest quality, ethical standards and in accordance with the international standards



Resistant

Our abrasion and wear resistant products come with different heights, colour options and unique characteristics



Long Lasting

Artificial turfs are easy to maintain and cheap, as well as have a very long life with low maintenance

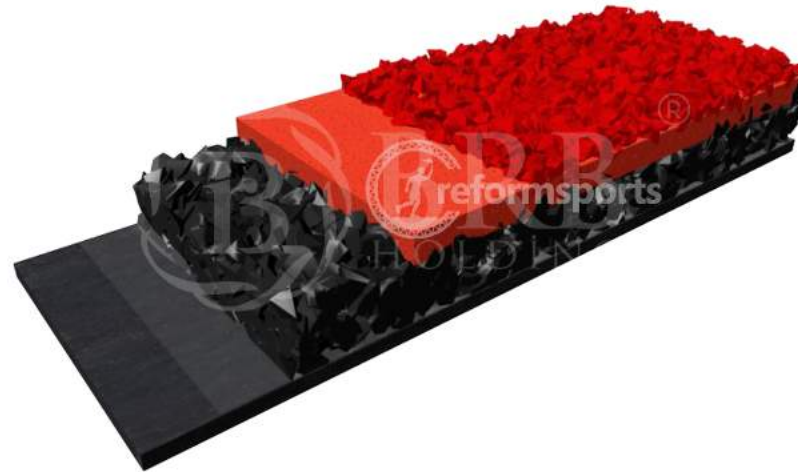

Natural Appearance

It is produced with monofilament yarns for aesthetic and more natural appearance



High UV Resistance

It is produced with special UV resistant additive. Besides being resistant to UV rays, it is also resistant to cold weather



Nature Friendly

Our products are manufactured with environmental awareness and consist of recyclable materials with the use of effective technology and components



Sandwich System Floor is durable, long lasting and resistant to all weather conditions. It can be used for international competitions. The system is water permeable and has shock absorbing. It is a ground resistant to puncture. The floor has a surface, which prevents slipping.



SANDWICH SYSTEM



reformsports.com



info@reformsports.com



+90 212 533 70 73



6 LANES
RUNNING
RACKS



ATHLETICS TRACK



reformsports.com



info@reformsports.com



+90 212 533 70 73

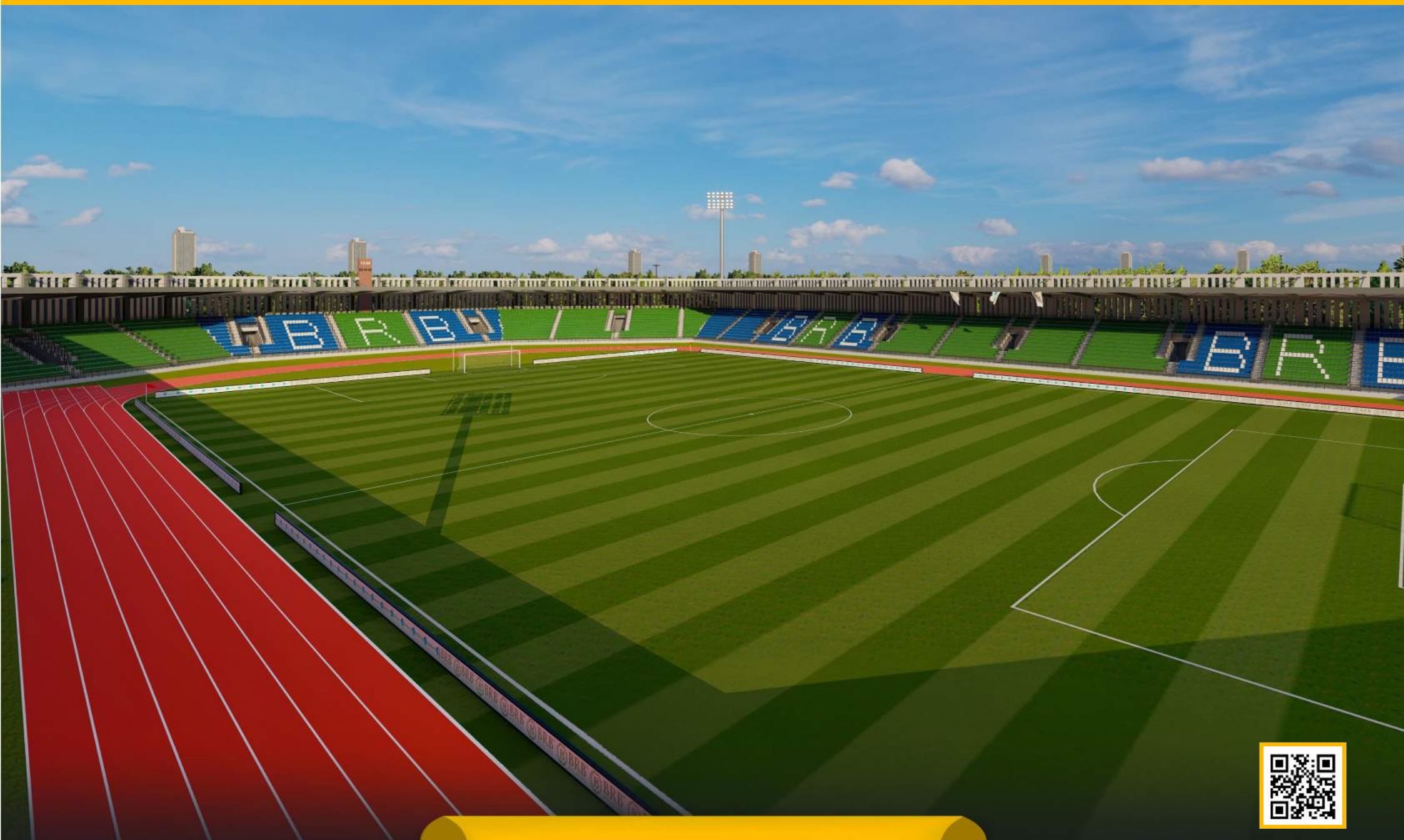

ATHLETICS TRACK



reformsports.com



info@reformsports.com



+90 212 533 70 73



15.000
SEATS
CAPACITY



TRIBUNES

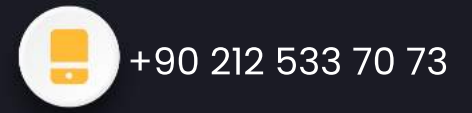

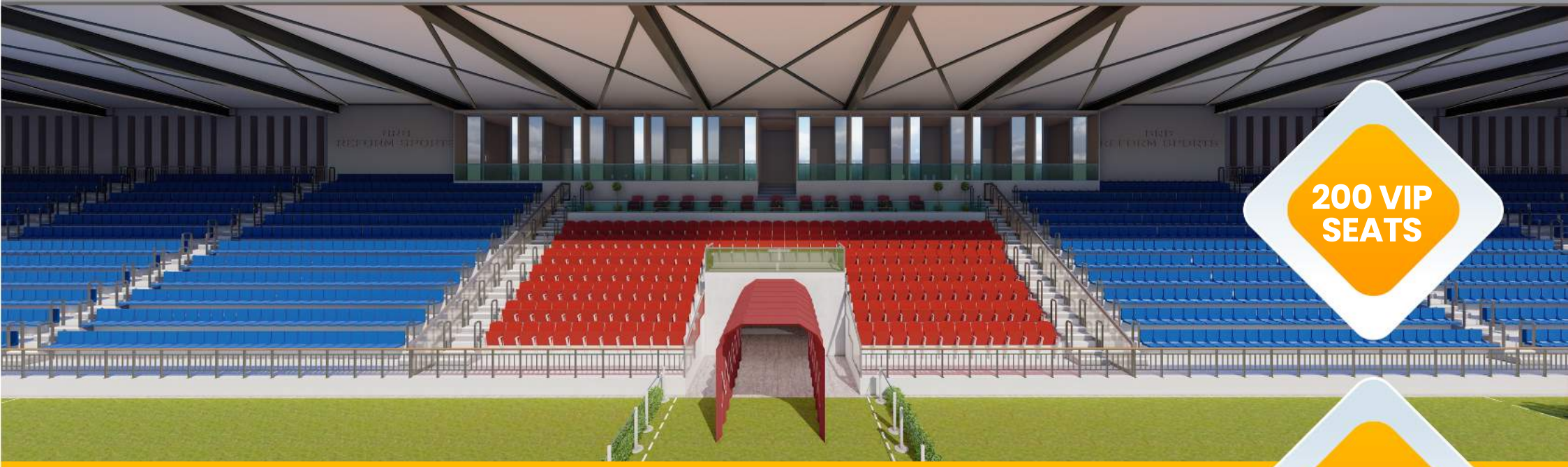

200 VIP SEATS



ERGONOMIC DESIGN



TRIBUNES

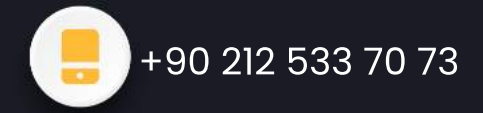

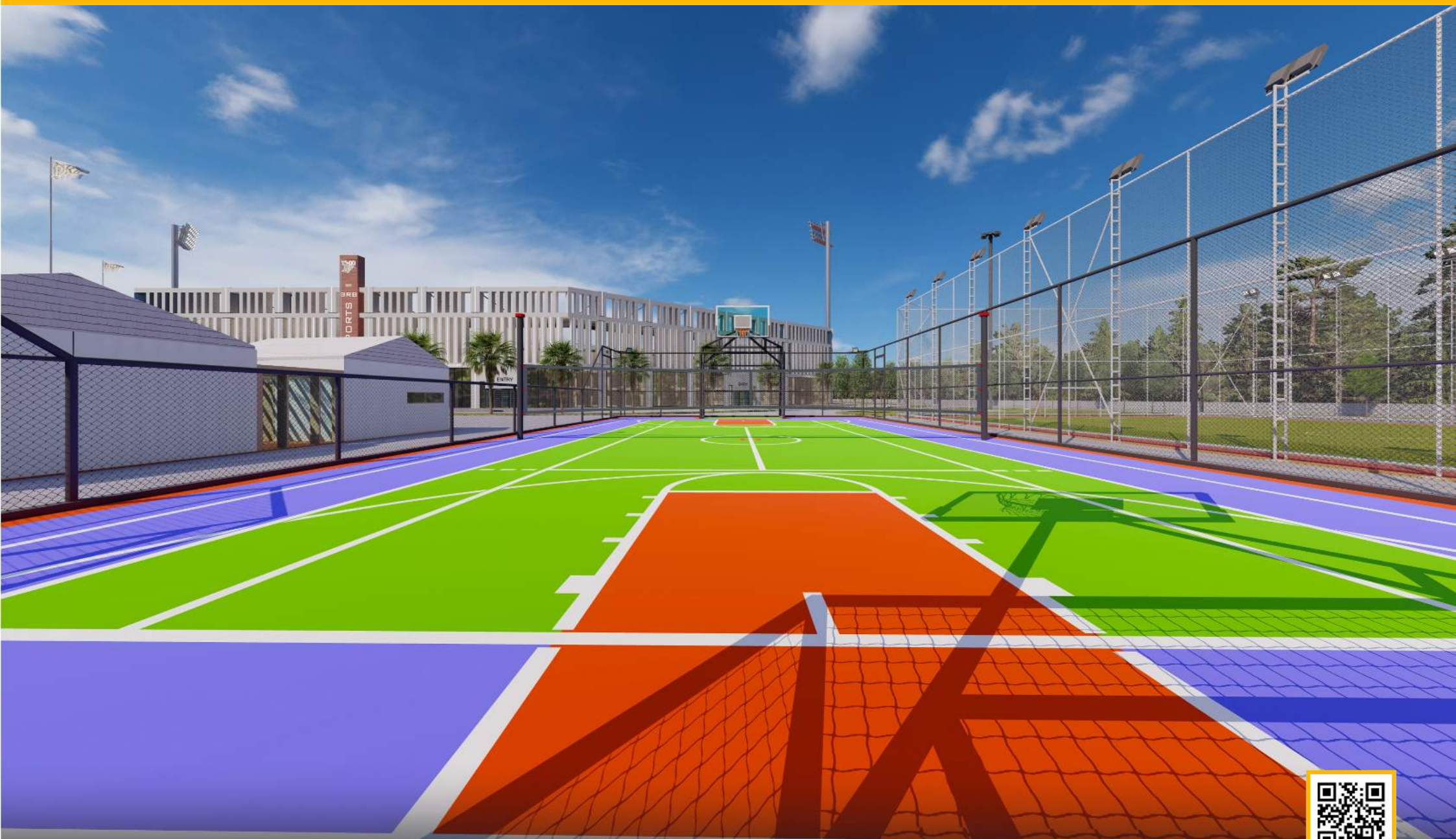

MULTI-PURPOSE SPORTS FIELD



reformsports.com



info@reformsports.com



+90 212 533 70 73

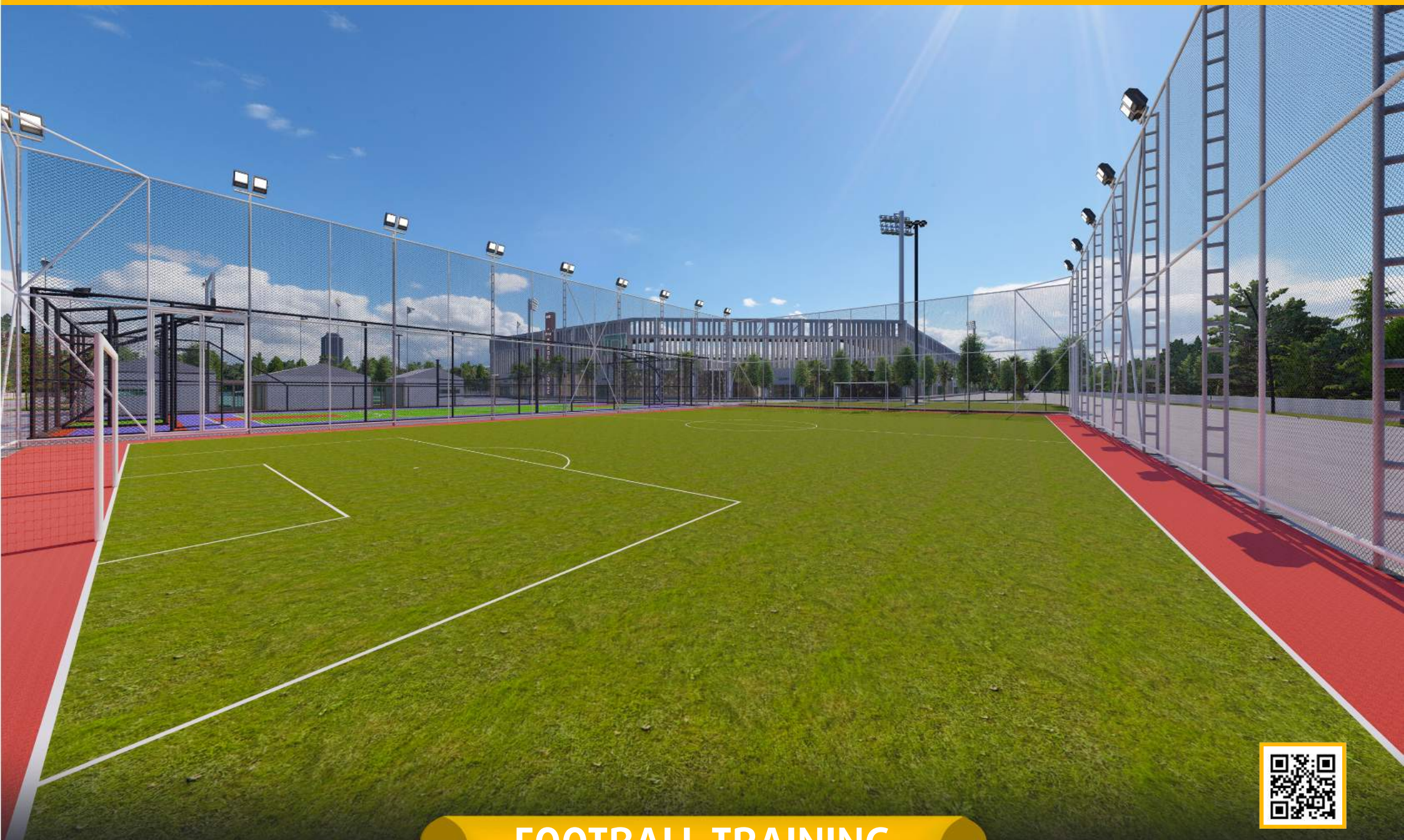

FOOTBALL TRAINING FIELD



reformsports.com



info@reformsports.com



+90 212 533 70 73



750 m²



INTERIOR

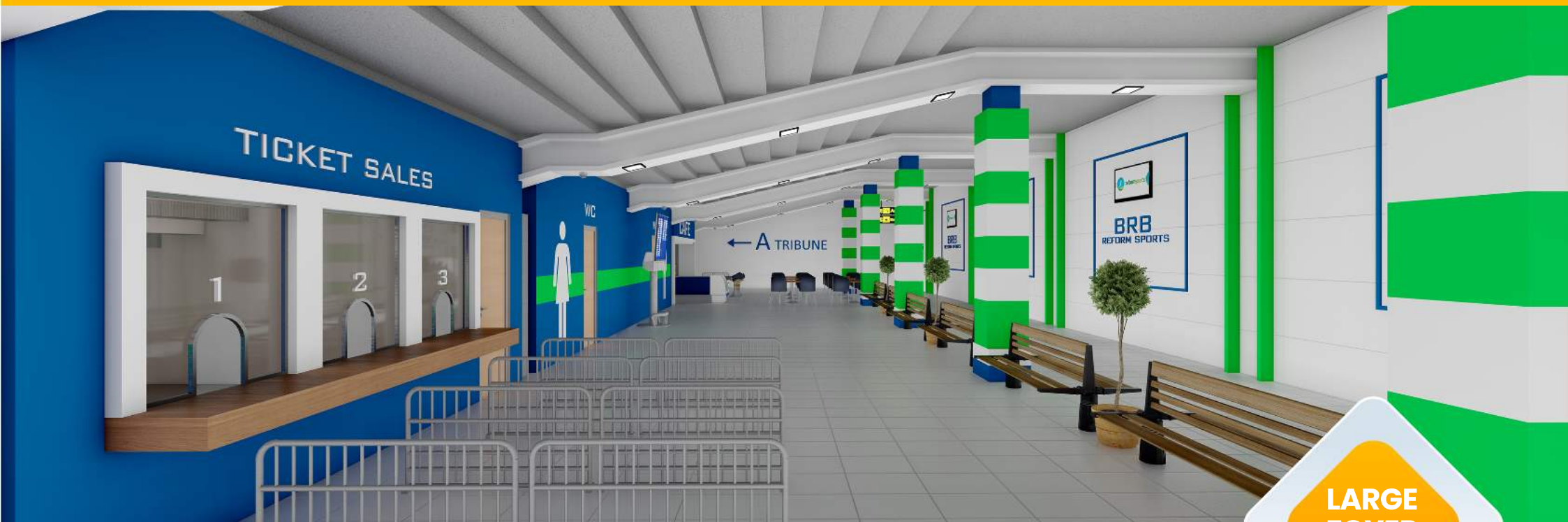

LARGE
FOYER
AREA



INTERIOR

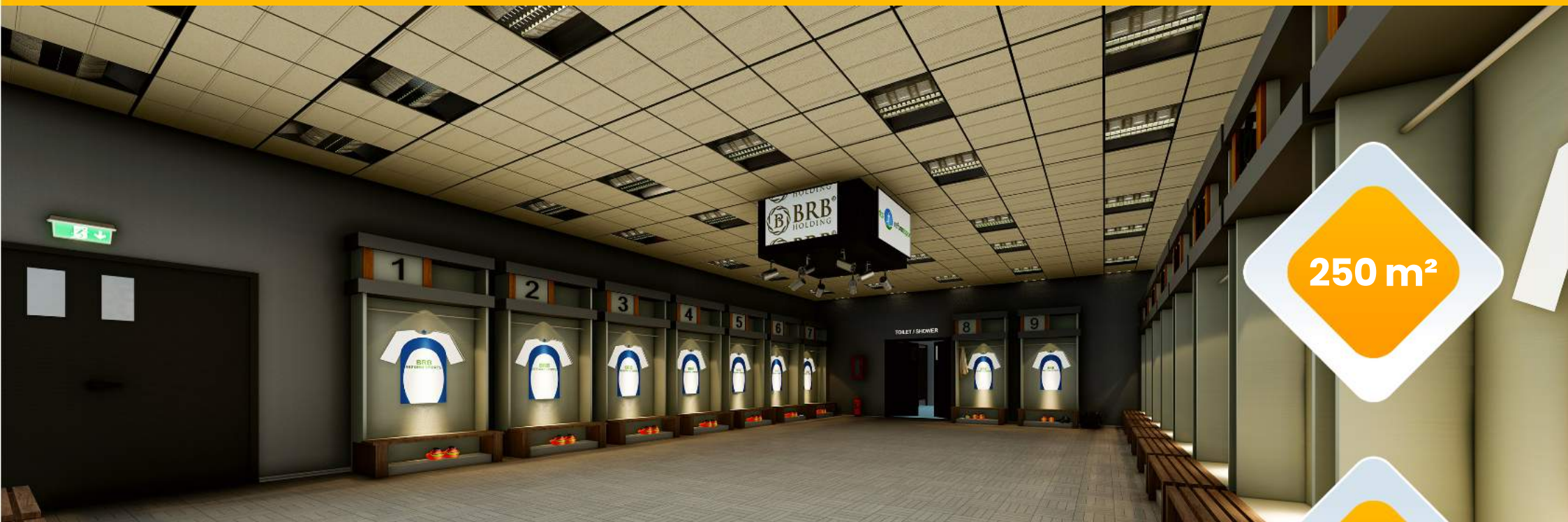

250 m²



2 FOR TEAMS



LOCKER ROOM



reformsports.com



info@reformsports.com



+90 212 533 70 73



120 M²
FOR
TEAMS



WC & BATHROOM



[reformsports.com](https://www.reformsports.com)



info@reformsports.com



+90 212 533 70 73



40 m²

MEDICAL ROOM



reformsports.com



info@reformsports.com



+90 212 533 70 73

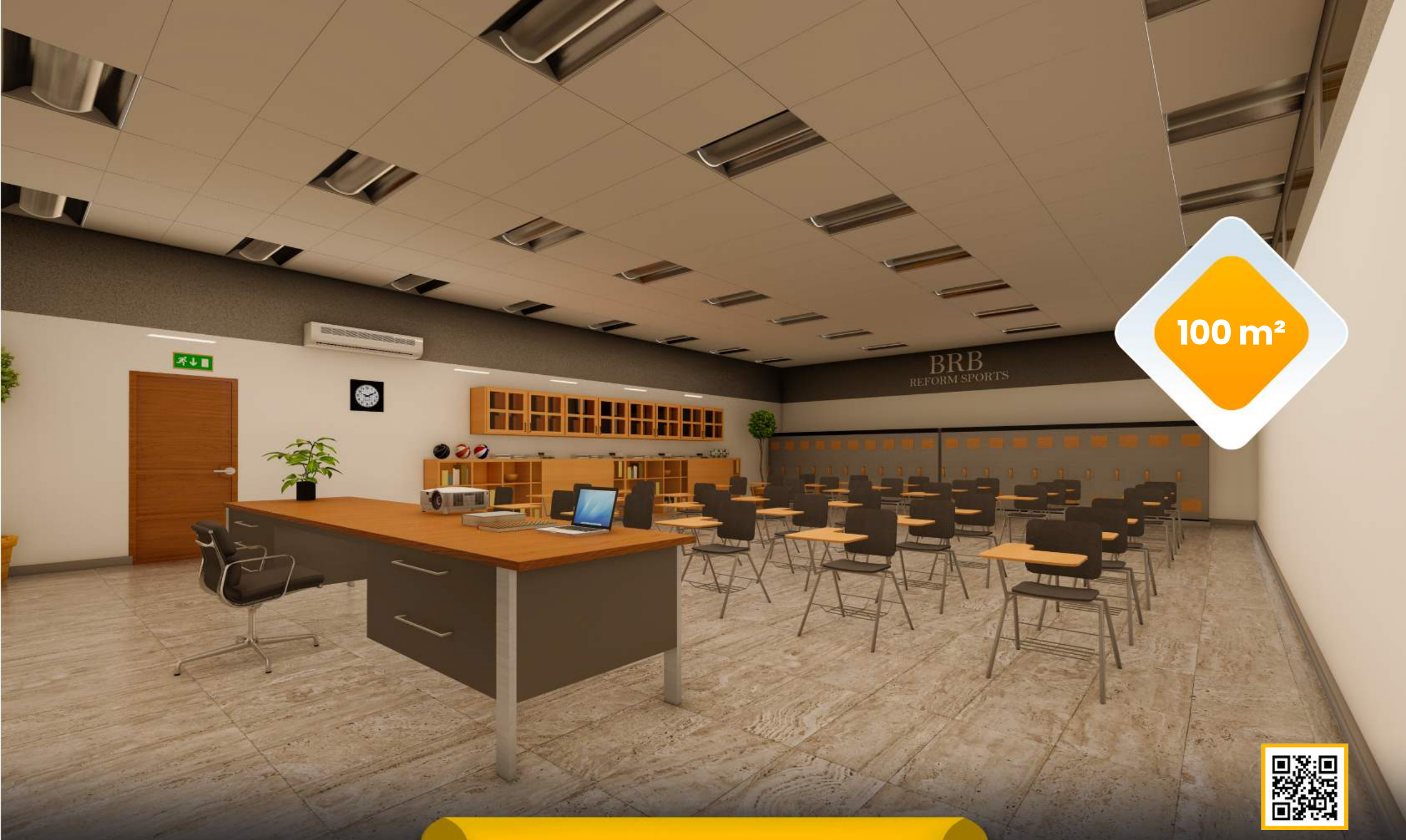

100 m²



SPORTS ACADEMY



reformsports.com



info@reformsports.com



+90 212 533 70 73



REFEREE ROOM

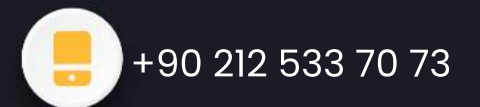
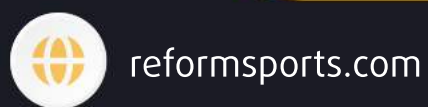



40 m²



TECHNICAL DIRECTOR'S ROOM



reformsports.com



info@reformsports.com



+90 212 533 70 73



100 m²



PRESS AND MEETING ROOM



reformsports.com



info@reformsports.com



+90 212 533 70 73

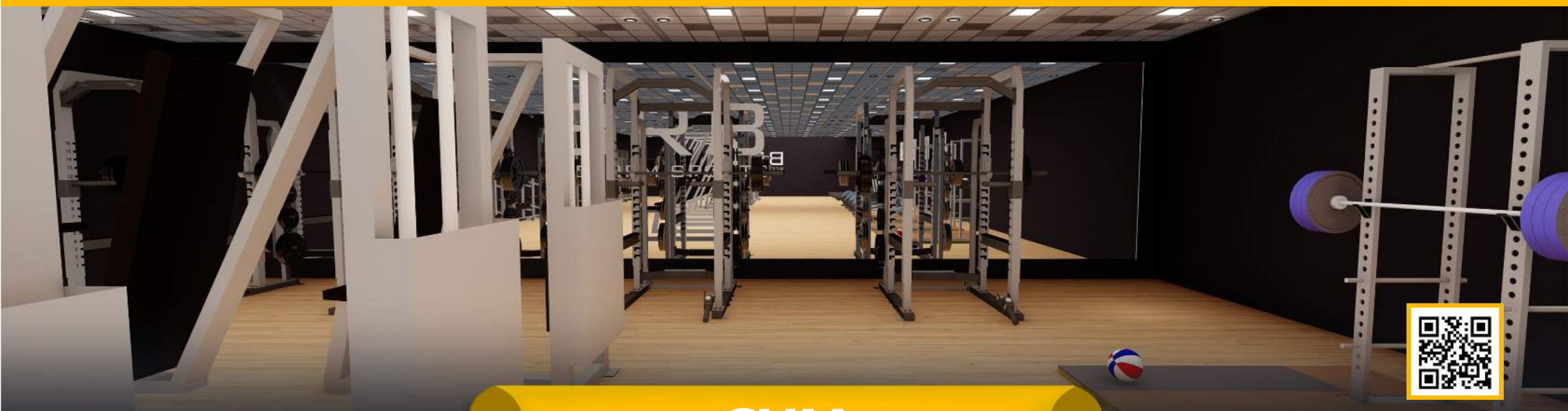

GYM



reformsports.com



info@reformsports.com



+90 212 533 70 73

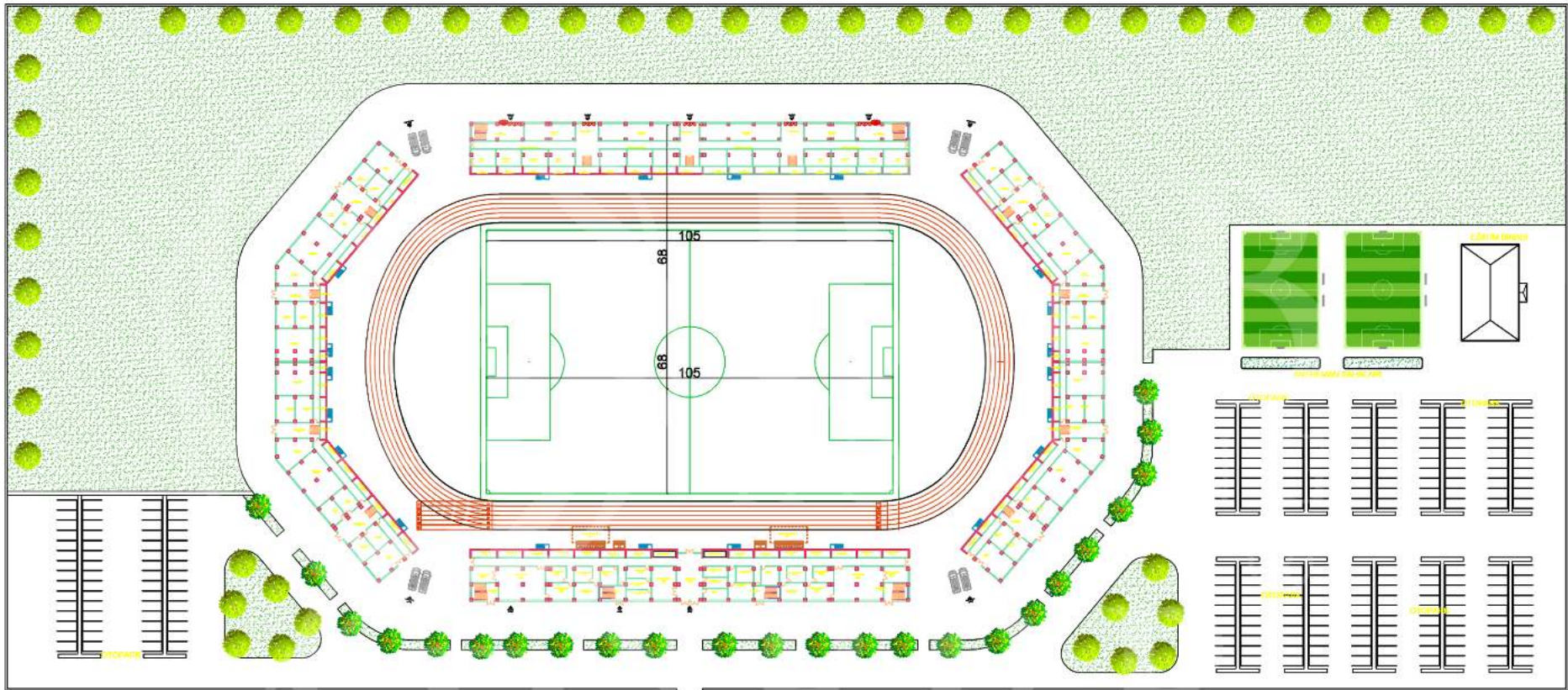

GENERAL LAYOUT

ARCHITECTURAL PLAN

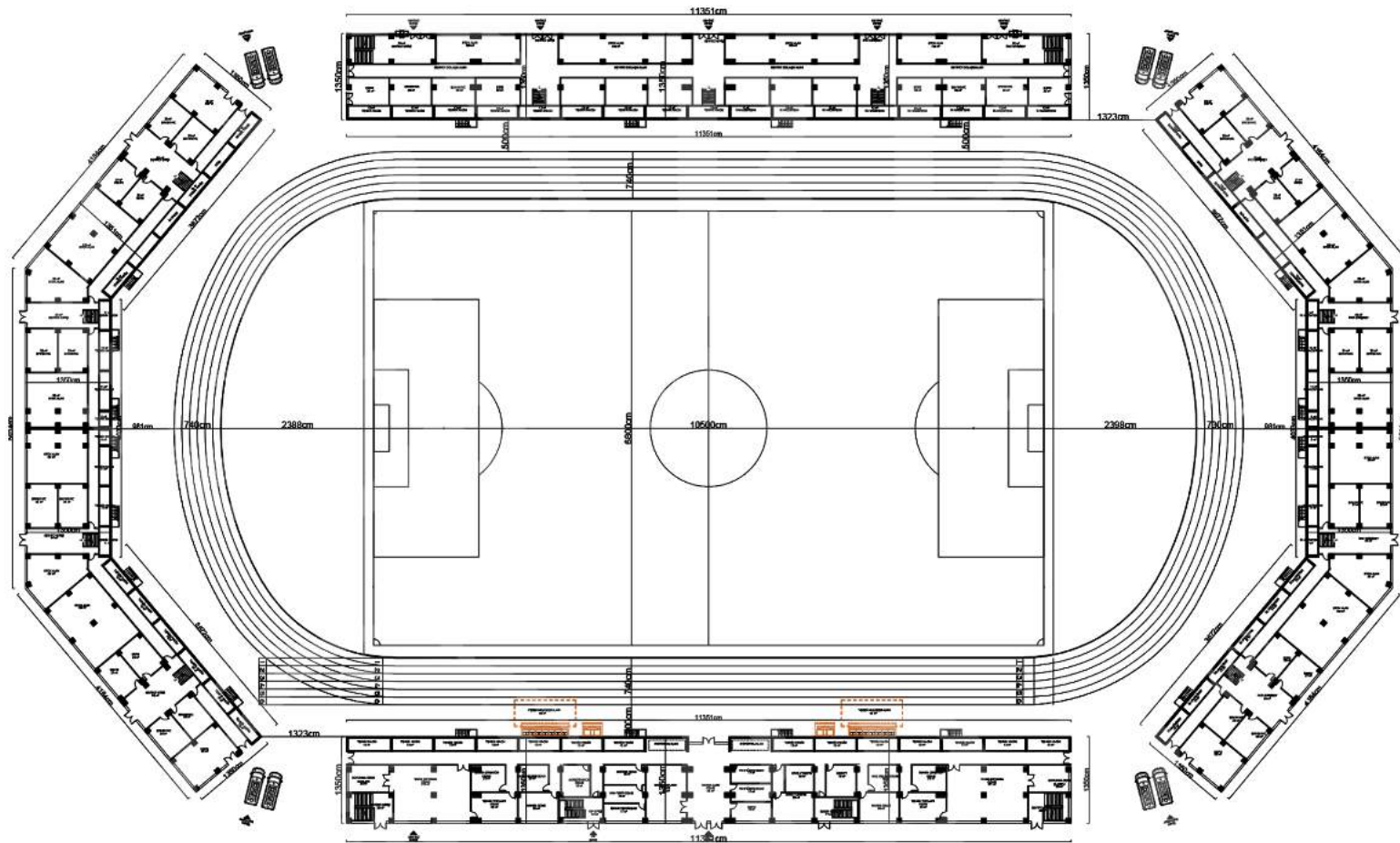

GROUND FLOOR ARCHITECTURAL PLAN

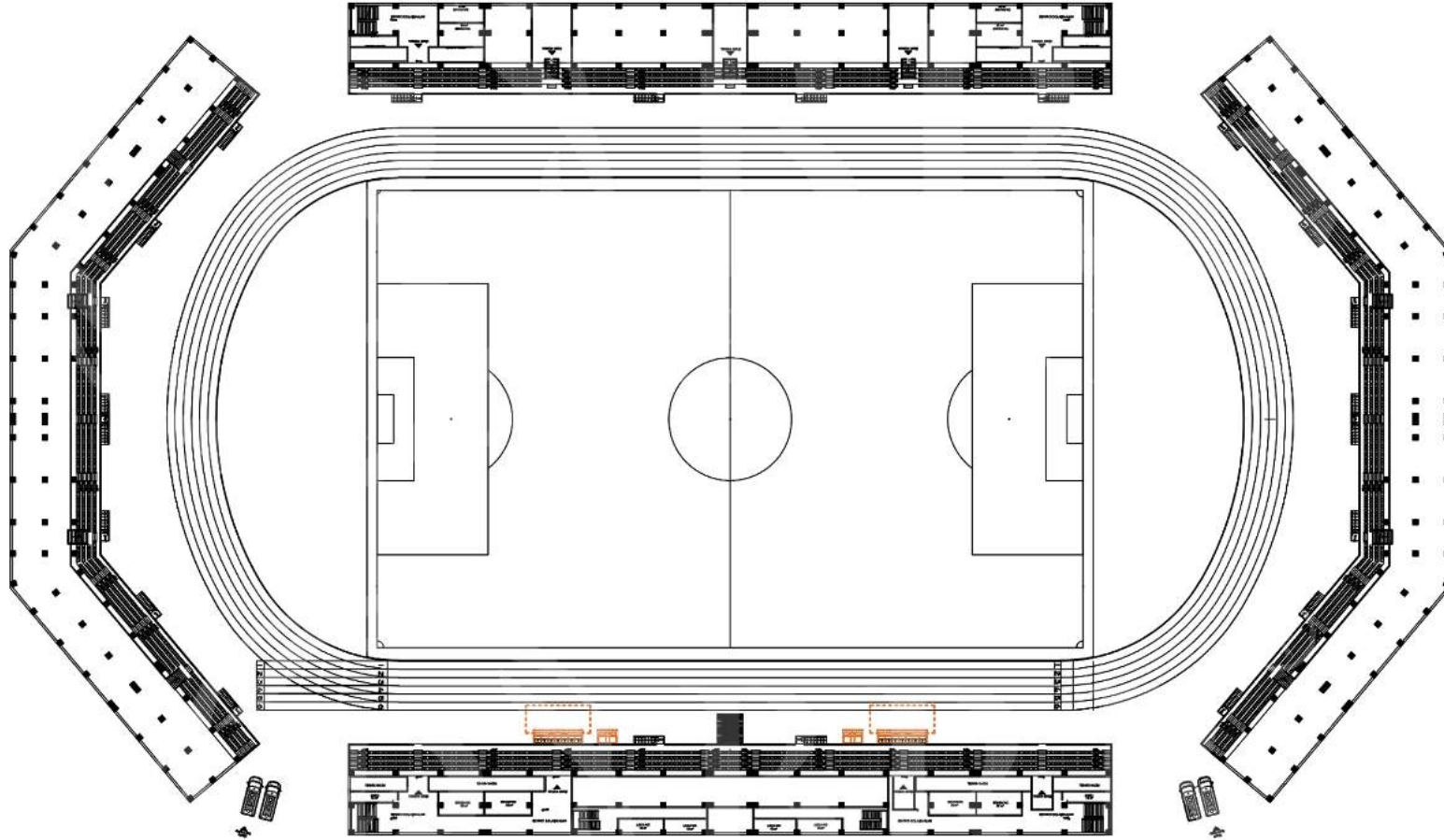

FIRST FLOOR ARCHITECTURAL PLAN

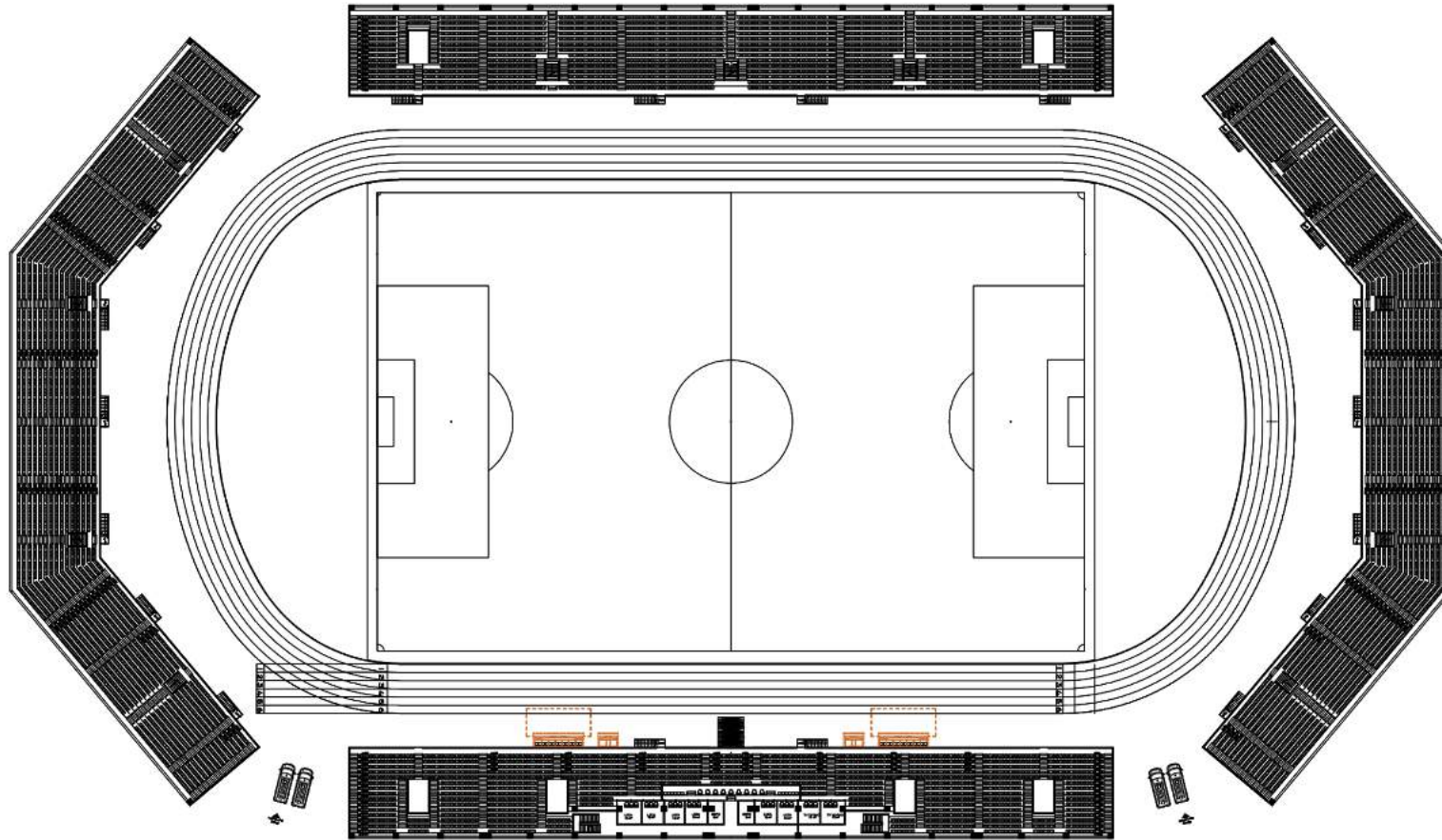

TRIBUNES

ARCHITECTURAL PLAN

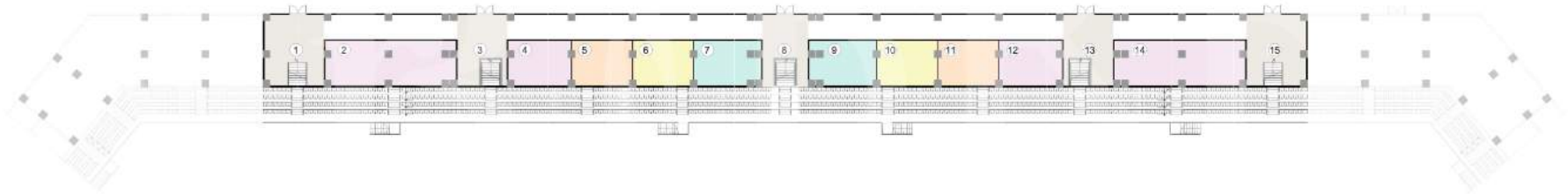

	NUMBER/	COLOUR/	SQUARE METERS/	VENUE NAME/
	SAYI	RENK	METREKARE	MAHAL ADI
SEHİRCİ TRİBÜNÜ	1		47.00 m ²	Audience Entry Seyirci Girişi
	2		65.00 m ²	Store Depo
	3		33.00 m ²	Audience Entry Seyirci Girişi
	4		31.00 m ²	Store Depo
	5		30.00 m ²	Buffet Büfe
	6		30.00 m ²	Woman's wc Bayan wc
	7		32.60 m ²	Male's wc Erkek wc
	8		30.00 m ²	Audience Entry Seyirci Girişi
	9		32.60 m ²	Male's wc Erkek wc
	10		30.00 m ²	Woman's wc Bayan wc
	11		30.00 m ²	Buffet Büfe
	12		31.00 m ²	Store Depo
	13		33.00 m ²	Audience Entry Seyirci Girişi
	14		65.00 m ²	Store Depo
	15		47.00 m ²	Audience Entry Seyirci Girişi

TRIBUNES

ARCHITECTURAL PLAN

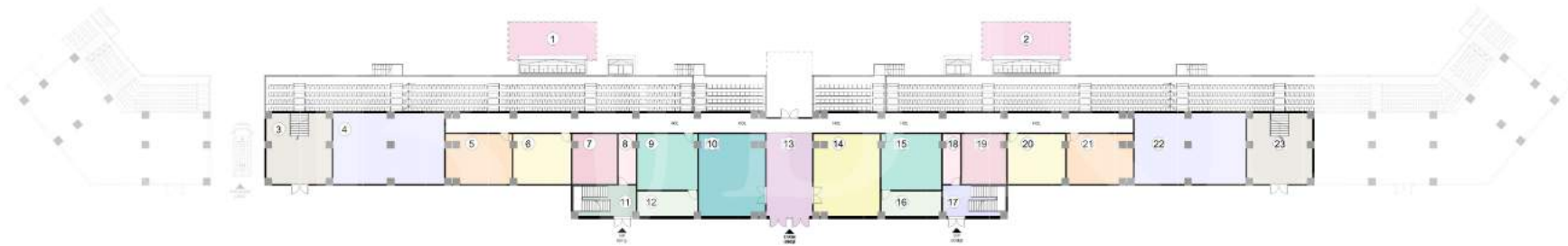

	NUMBER/ SAYI	COLOUR/ RENK	SQUARE METERS/ METREKARE	VENUE NAME/ MAHAL ADI		NUMBER/ SAYI	COLOUR/ RENK	SQUARE METERS/ METREKARE	VENUE NAME/ MAHAL ADI
MARATON TRIBÜNÜ	1		55.00 m ²	Reserve Bench Area Yedek Kulübesi Alanı	MARATON TRIBÜNÜ	16		17.00 m ²	Urine Test Room İdrar Testi Odası
	2		55.00 m ²	Reserve Bench Area Yedek Kulübesi Alanı		17		10.00 m ²	Press Entrance Basın Girişi
	3		46.00 m ²	Audience Entry Seyirci Girişi		18		10.00 m ²	Stair Hall Merdiven Holü
	4		90.00 m ²	Changing rooms-Showers Boyunma odası ve Duşlar		19		25.00 m ²	Accreditation's Room Akrediasyon Odası
	5		36.00 m ²	Team Dressing Room Takım Soyunma Odası		20		33.00 m ²	Technical Director's Room Teknik Direktör Odası
	6		33.00 m ²	Technical Director's Room Teknik Direktör Odası		21		36.00 m ²	Team Dressing Room Takım Soyunma Odası
	7		25.00 m ²	Accreditation's Room Akrediasyon Odası		22		90.00 m ²	Changing rooms-Showers Boyunma odası ve Duşlar
	8		10.00 m ²	Stair Hall Merdiven Holü		23		46.00 m ²	Audience Entry Seyirci Girişi
	9		38.00 m ²	Blood Test Room Kan Testi Odası					
	10		61.00 m ²	Press Conference Room Basın Toplantı Odası					
	11		10.00 m ²	VIP Entrance VIP Girişi					
	12		17.00 m ²	Urine Test Room İdrar Testi Odası					
	13		44.00 m ²	Mixed Field Karma Alan					
	14		61.00 m ²	Mosque Mescit					
	15		38.00 m ²	Blood Test Room Kan Testi Odası					

TRIBUNES

ARCHITECTURAL PLAN

KALE ARKASI GÜNEY/ CASTLE BACK SOUTH

NUMBER/ SAYI	COLOUR/ RENK	SQUARE METERS/ METREKARE	VENUE NAME/ MAHAL ADI	NUMBER/ SAYI	COLOUR/ RENK	SQUARE METERS/ METREKARE	VENUE NAME/ MAHAL ADI
1		200.00 m ²	Store Depo	13		64.00 m ²	Stock Area Stok Alan
2		17.00 m ²	Male's wc Erkek wc	14		20.00 m ²	Male's wc Erkek wc
3		25.95 m ²	Woman's wc Bayan wc	15		29.65 m ²	Woman's wc Bayan wc
4		36.00 m ²	Audience Entry Seyirci Girişi	16		25.80 m ²	Audience Entry Seyirci Girişi
5		16.50 m ²	Infirmary Revir	17		42.00 m ²	Stock Area Stok Alan
6		26.00 m ²	Buffet Bufo	18		88.00 m ²	Stock Area Stok Alan
7		88.00 m ²	Stock Area Stok Alan	19		26.00 m ²	Buffet Bufo
8		42.00 m ²	Stock Area Stok Alan	20		16.50 m ²	Infirmary Revir
9		25.80 m ²	Audience Entry Seyirci Girişi	21		38.00 m ²	Audience Entry Seyirci Girişi
10		20.00 m ²	Male's wc Erkek wc	22		17.00 m ²	Male's wc Erkek wc
11		29.65 m ²	Woman's wc Bayan wc	23		25.95 m ²	Woman's wc Bayan wc
12		64.00 m ²	Stock Area Stok Alan	24		200.00 m ²	Store Depo

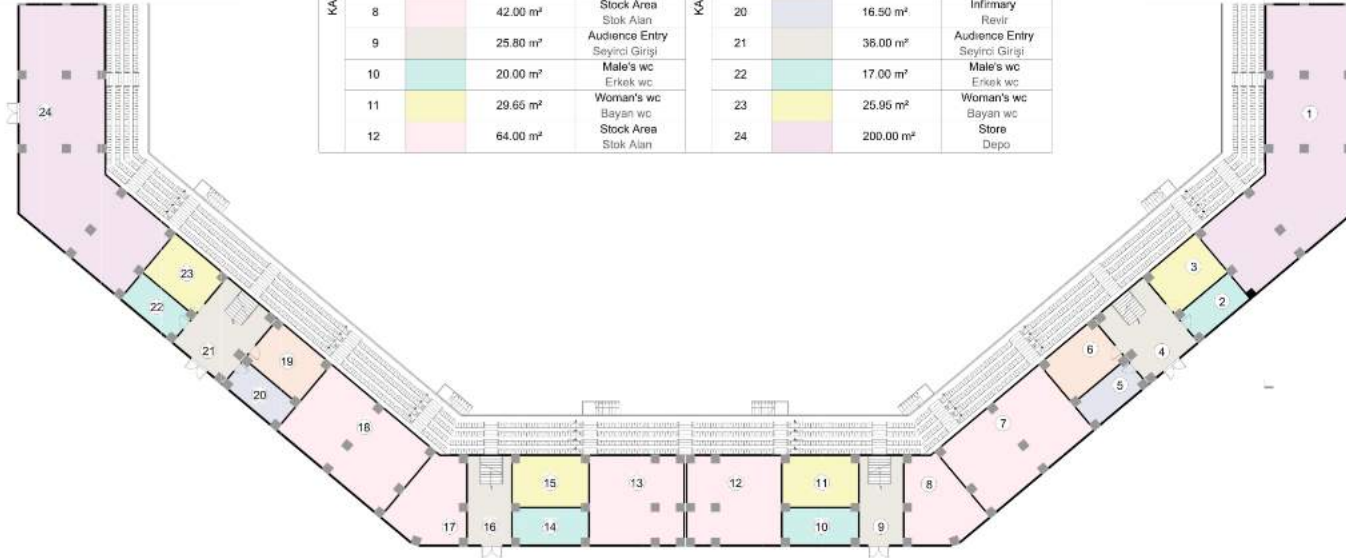

TOPLAM NET ALAN / TOTAL NET AREA 1.181.30 m²

TRIBUNES ARCHITECTURAL PLAN

KALE ARKASI KUZHEY/ CASTLE BACK NORTH

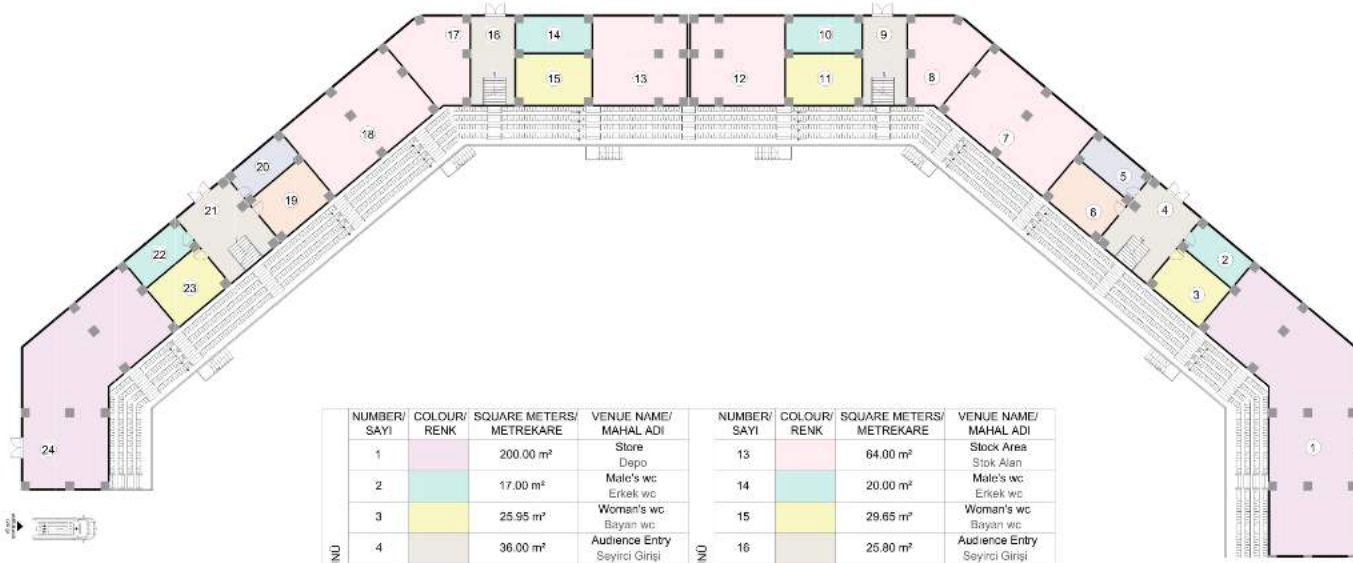

NUMBER/ SAYI	COLOUR/ RENK	SQUARE METERS/ METREKARE	VENUE NAME/ MAHAL ADI	NUMBER/ SAYI	COLOUR/ RENK	SQUARE METERS/ METREKARE	VENUE NAME/ MAHAL ADI
1		200.00 m ²	Store Dapo	13		64.00 m ²	Stock Area Stok Alan
2		17.00 m ²	Male's wc Erkek wc	14		20.00 m ²	Male's wc Erkek wc
3		25.95 m ²	Woman's wc Bayan wc	15		29.65 m ²	Woman's wc Bayan wc
4		36.00 m ²	Audience Entry Seyirci Girişi	16		25.80 m ²	Audience Entry Seyirci Girişi
5		16.50 m ²	Infirmary Revir	17		42.00 m ²	Stock Area Stok Alan
6		26.00 m ²	Buffet Büfe	18		88.00 m ²	Stock Area Stok Alan
7		88.00 m ²	Stock Area Stok Alan	19		26.00 m ²	Buffet Büfe
8		42.00 m ²	Stock Area Stok Alan	20		16.50 m ²	Infirmary Revir
9		25.80 m ²	Audience Entry Seyirci Girişi	21		36.00 m ²	Audience Entry Seyirci Girişi
10		20.00 m ²	Male's wc Erkek wc	22		17.00 m ²	Male's wc Erkek wc
11		29.65 m ²	Woman's wc Bayan wc	23		25.95 m ²	Woman's wc Bayan wc
12		64.00 m ²	Stock Area Stok Alan	24		154.00 m ²	Store Depo

TOPLAM NET ALAN / TOTAL NET AREA 1.181.30 m²

TRIBUNES ARCHITECTURAL PLAN



reform[®]
sports



www.reformsports.com